

HARNEY COUNTY



SCHOOL DISTRICT 3

LONG-RANGE FACILITIES REPORT



ISSUANCE:

FINAL REPORT – August 30, 2019

PREPARED IN COMPLIANCE WITH
STANDARDS DEFINED AS PER THE



Scott Marshall, AIA-NCARB
Certified State of Oregon
Department of Education Assessor

Principal – Architect, AIA-NCARB
STRAIGHTLINE ARCHITECTURE
Oregon – Idaho – Montana – New Mexico



HARNEY COUNTY SCHOOL DISTRICT 3

Long Range Facilities Plan

TABLE OF CONTENTS *Page*

INTRODUCTION **3**

1. DISTRICT PLANNING **4**

DISTRICT OVERVIEW 4

RENOVATION AND ADDITION HISTORY 5

DISTRICT BONDS 6

2. DISTRICT EDUCATIONAL STANDARDS **8**

CORE EDUCATIONAL STANDARDS 8

SPECIAL EDUCATION 8

ELEMENTARY SCHOOL STANDARDS 9

MIDDLE AND HIGH SCHOOL STANDARDS 9

PROVISION STANDARDS 10

3. FACILITIES INVENTORY **11**

DISTRICT FACILITIES OVERVIEW 11

SLATER ELEMENTARY SCHOOL – FACILITIES OVERVIEW 12

SLATER ELEMENTARY SCHOOL – CLASSROOM INVENTORY 13

SLATER ELEMENTARY SCHOOL – ADMINISTRATIVE & MAINTENANCE INVENTORY 16

SLATER ELEMENTARY SCHOOL – STORAGE INVENTORY 18

SLATER ELEMENTARY SCHOOL – BATHROOM INVENTORY 20

HINES MIDDLE SCHOOL – FACILITIES OVERVIEW 22

HINES MIDDLE SCHOOL – CLASSROOM INVENTORY 23

HINES MIDDLE SCHOOL – ADMINISTRATIVE & MAINTENANCE INVENTORY 26

HINES MIDDLE SCHOOL – STORAGE INVENTORY 28

HINES MIDDLE SCHOOL – BATHROOM INVENTORY 30

BURNS HIGH SCHOOL – FACILITIES OVERVIEW 32

BURNS HIGH SCHOOL – CLASSROOM INVENTORY 33

BURNS HIGH SCHOOL – ADMINISTRATIVE & MAINTENANCE INVENTORY 37

BURNS HIGH SCHOOL – STORAGE INVENTORY 40

BURNS HIGH SCHOOL – BATHROOM INVENTORY	42
DISTRICT OFFICE – FACILITIES OVERVIEW	44
DISTRICT OFFICE – ADMINISTRATIVE & MAINTENANCE INVENTORY	45
DISTRICT OFFICE – STORAGE INVENTORY	47
DISTRICT OFFICE – BATHROOM INVENTORY	49
4. SCHOOL CAPACITY	51
SLATER ELEMENTARY SCHOOL CAPACITY	51
HINES MIDDLE SCHOOL CAPACITY	52
BURNS HIGH SCHOOL CAPACITY	53
5. ENROLLMENT PROJECTIONS	54
DISTRICT POPULATION PROJECTIONS	54
SLATER ELEMENTARY SCHOOL – ENROLLMENT PROJECTIONS.....	56
SLATER ELEMENTARY SCHOOL – TEACHER TO STUDENT RATIO PROJECTIONS.....	58
HINES MIDDLE SCHOOL – ENROLLMENT PROJECTIONS	59
HINES MIDDLE SCHOOL – TEACHER TO STUDENT RATIO PROJECTIONS	61
BURNS HIGH SCHOOL – ENROLLMENT PROJECTIONS	62
BURNS HIGH SCHOOL – TEACHER TO STUDENT RATIO PROJECTIONS.....	64
6. DISTRICTS FACILITIES NEEDS	65
FUTURE CAPACITY REQUIREMENTS.....	65
7. DISTRICT FACILITIES FINANCING	66
PRELIMINARY BOND SCOPE OF WORK & BUDGET	66
8. CONCLUSIONS AND RECCOMENDATIONS.....	67
BOND APPROACH & CONSOLIDATION NARRATIVE.....	67
BOND SCOPE OF WORK	68
SLATER K-8 FACILITY PRELIMINARY PROGRAMMING GRAPHIC	69
HIGH SCHOOL PRELIMINARY PROGRAMMING GRAPHIC	70
HINES PRELIMINARY PROGRAMMING.....	71
9. APPENDICES.....	72
APPENDIX A: <i>SITE INFORMATION</i>	72
APPENDIX B: <i>SOURCES</i>	75
APPENDIX C: BOND ANALYSIS.....	1 THRU 3



Harney County SCHOOL DISTRICT

"Home of the Bulldogs, Scotties, and Highlanders"



Mission Statement

"Harney County School District #3 is committed to inspiring students by providing quality employees, facilities, and promoting community involvement."

Introduction

The Harney County School District is a relatively smaller district centrally located around the two conjoining cities of Burns and Hines in Central Oregon within Harney County. The district provides access to their schools to those living within city limits of Burns and Hines along with those living in the outlying rural scope the district covers. The district maintains a single elementary school, a single middle school, and a single high school all situated on three separate parcels of land marking a total of 48.47 acres of district-owned land within city limits of Burns and Hines.

The long-range facility plan reports on the condition of all present facilities and their operating components in correlation with the district's established educational standards and perceived future needs. Enrollment tendencies and forecasts, mechanical and electrical inspections, maintenance and improvement expenses, and projected facility demands forward of 20 years will all be addressed along with inspection recommendations and insight.

The principal objective of the long-range facility plan is to safeguard the district's mission statement promise to the students and community to provide 'Educational excellence and lifelong learning'. This report will outline and provide conclusions based upon all aspects of the districts needs to solidify a proactive approach, rather than a reactive response to ongoing population growth, changes to the districts educational needs, and overall facility readiness.

Overall, the information contained herein will ensure that all current and future educational and support facilities are maintained and established to contest fluctuations, and to guarantee a comfortable and superlative teaching and learning environment for both the students and staff.

District Overview

The Harney County School District is the only official school district within Harney County. The district's boundaries encompass Harney County's northern expanse directly along the border with John Day School District. As for the district itself, it encompasses a total of 1,308 sq. miles housing a total of 5,621 residents within its boundaries. The district's two communities Burns and Hines, house roughly 74.9% (4,309 residents) of the district's total population, with the remaining 25.1% (1,312 residents) of the population inhabiting the outlying rural scope of the district outside sanctioned city limits. Of the total population, 20.25% (1,138 residents) are under the age of 18, which is 3.76% lower than the national average however only 1.38% lower than the Oregon state average per the most recent census data available. Our data also indicates that the immigration rate is nearly identical to the emigration rate, meaning that there is little to no loss or gain to the population of the district on that basis. Overall district enrollment as of 2017-2018 school year sits at 899 students K-12.

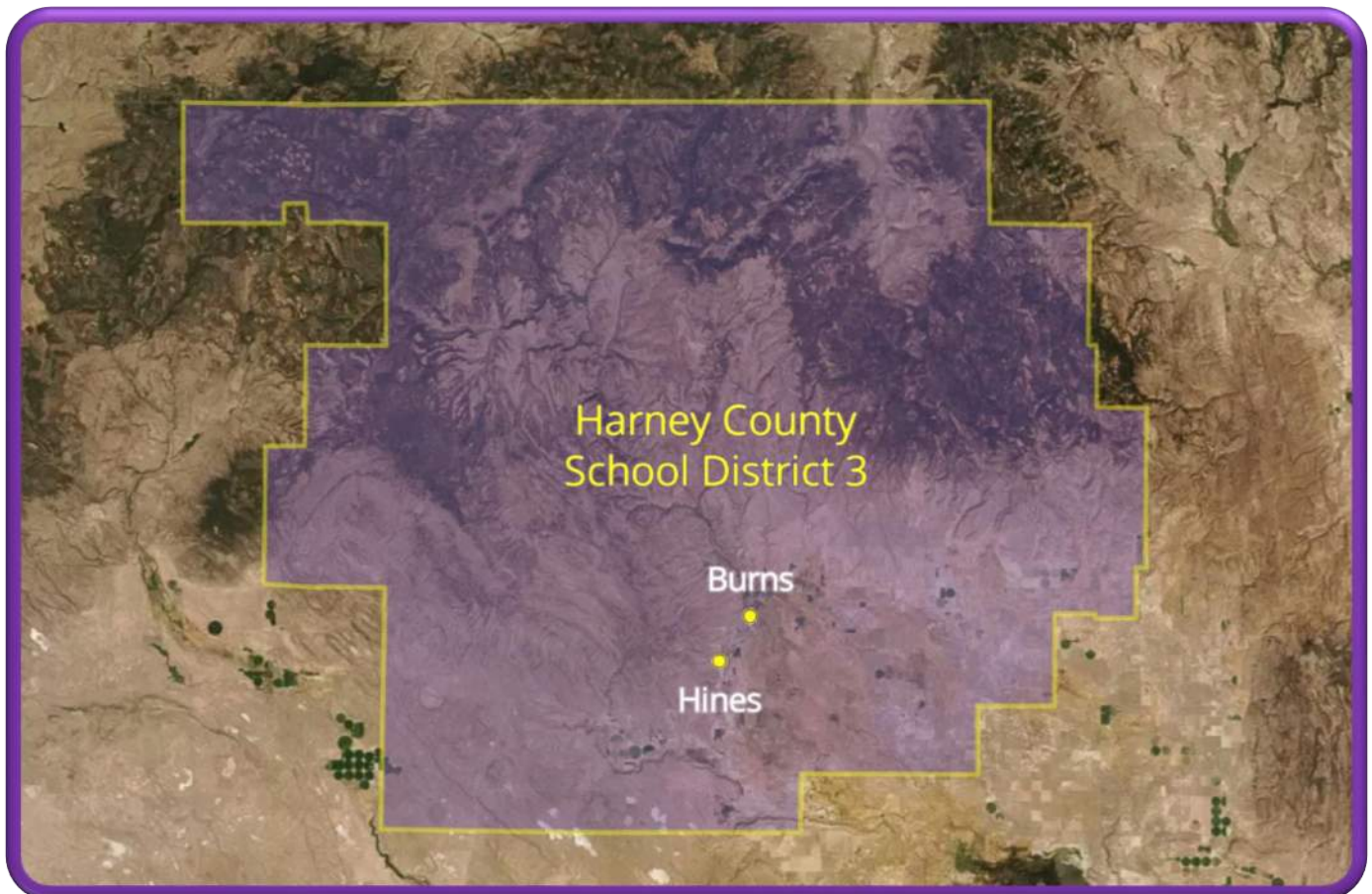

Harney County School District 3 Boundaries
(Figure 1.1)

Major Rennovation & Additions History

The Harney County School District maintains (3) campuses, located within the cities of Burns and Hines in Oregon State. Hines Middle School was originally the community's grade school constructed in 1930 at the height of the early 20th century Oregon lumber boom, and now acts as the districts only middle school. Slater Elementary School was constructed in 1948 built over the site of the community's first school. Burns High School was constructed in 1959 soon after its predecessor burnt down in 1958.

- 1928 ----- District Office (original middle school)
- 1930 ----- Middle School Facility (original grade school)
- 1948 ----- Elementary School Facility
- 1959----- High School Facility

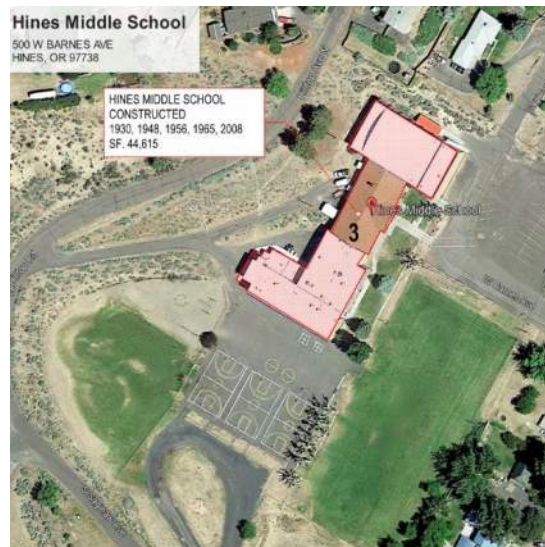
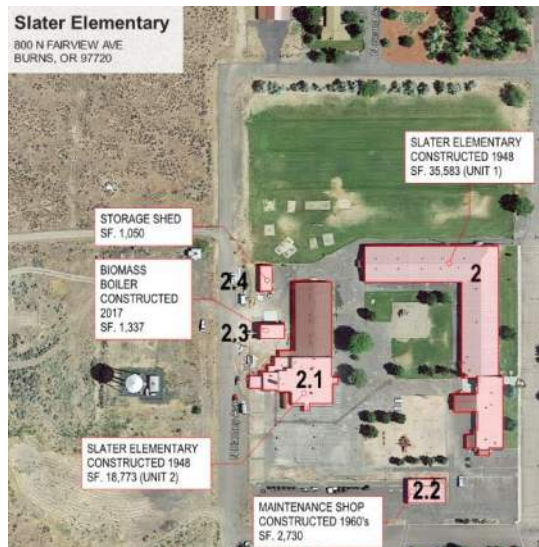

District Bond Summary

The Harney County school Board voted on August 12th, 2019 to pass resolution to run an \$8M school bond Campaign to be voted on in May of 2020. The Board also indicated that they would be pursuing the OSCIM grant requesting a \$4M fund amount. The bond duration will be presented as a 30-year note.

The School District has been working with their financial Bond advisor DA Davidson. The finding of the bonding analysis is included in this report under Appendix 'C'.

Current Planning Approach

The School District's School Board of Directors Meets each month, in a public forum, to review and discuss the districts needs and business. Over the past few months, the urgent need to address deferred maintenance, security, safety, and facility remodel & replacement has been a recurring general topic of discussion.

In the Spring of 2018 the district initiated Straightline Architecture to compose this document as well as a comprehensive Facilities Condition Assessment in order to prioritize facility work and align the district for OSCIM grant eligibility.

Starting in May of 2019 the school district formed a 8 person building committee. Members of the committee were be hand selected based upon construction experience, community ties, and the need to properly represent the community.

The Building Committee was formed to represent the community, maintenance personal, teachers, and staff so as to determine facility improvement wants and needs. This effort, joined with review of the Facilities Condition Assessment, resulted in composing a preliminary list of facility improvements.

Straightline Architecture has compiled a preliminary list of deficiencies based upon this reports findings. The detailed list can be found in the Conclusions and Recommendations portion of this report (Page 67)

District Bond Campaign Approach

Over the next six months the Building Committee, along with support from the board of directors and School Superintendent, will move forward with a school bond campaign comprising of the following:

- Form a Building Committee to determine Bond Scope
- Complete and submit both the Long Range Facilities Plan and Facility Assessment reports to the Oregon Department of Education.
- Apply for consideration of the OSIM matching funds Grant.
- Advertise an RFQ for selection of an Architect / Design Team.
- Finalize the Facilities Upgrade / Project list
- Prepare materials for public involvement and awareness.
- Form Public awareness Bond Passage sub-groups
- Hold public presentations highlighting project and tax implications
- Conduct public tours of the existing school facilities
- Compose on-line video / informational materials
- Distribute handouts / flyers / post information in high traffic areas
- Visit and inform outlying district / high tax burden population

Core Educational Standards

- ❖ Sufficient classroom space for all curriculum areas associated to all grade levels to ensure a steady and comfortable learning environment.
- ❖ Physical education space is needed to ensure that all students meet physical fitness and health standards.
- ❖ Theatre, art, and music spaces are needed to ensure standards in these subject areas are met.
- ❖ Library and media services space for students to provide the necessary access to learning tools and material regarding course curriculums and programs.
- ❖ Science lab spaces that support high-level scientific coursework to meet state mandated science standards.
- ❖ Spaces allotted for technological equipment providing classroom application to deliver expected technological competency among all students.
- ❖ Space provided to adequately support school extracurricular programs and activities.

Special Education

- ❖ Programs and services fluctuate in correspondence to the students' individual education plans (IEP).
- ❖ Implementing multiple IEP's requires specialty space provided by the district. Special education program standards change as a result of varying influences such as funding allocation mandates, federal mandate, increase in number of IEP students, class size, grade configurations, facility changes, program modifications, and introduction of new technological applications, which directly effects needed space.
- ❖ IEP students receive additional support and space through Title I, ELL, and Special Education Programs.

Elementary School Standards

- ❖ Grade levels KG-3 class sizes are not to exceed 25 students per classroom.
- ❖ Grade levels 4-6 class sizes are not to exceed 30 students per classroom.
- ❖ The average class size and the maximum class size shall be based on regular classroom teaching positions, exclusive of principal, assistant principal, counselor, elementary art, elementary music, elementary physical education, librarian, special education, or other specialized positions.
- ❖ Space must be made available to students to provide physical education indoors during inclement weather.
- ❖ Computer labs must be available to all students, and space for technology in the classroom must also be provided.
- ❖ Special Education services are provided in a separate classroom, while other highly specialized spaces be made available for students with specific conditions.
- ❖ Specialty curriculums and programs require adequate instructional areas and spaces.
- ❖ Elementary students will have access to a sufficient media center and library.

Middle and High School Standards

- ❖ Grade levels 7-12 class sizes are not to exceed 35 students per classroom.
- ❖ Career and Technical Education class sizes are not exceed 25 students per classroom.
- ❖ A specialized science lab for grades 7-12 will be made available.
- ❖ Physical Education instruction must be available both in indoor and outdoor settings.
- ❖ Special Education services are provided in a separate classroom, while other highly specialized spaces be made available for students with specific conditions.
- ❖ Students 7-12 will be provided with classroom designated programs such as:
 - Media Center
 - Computer Lab(s)
 - Individual and large group study rooms
 - Art areas
 - Practice Lab(s)
 - Production Rooms
 - Wood Shop, Metal Shop
 - Agricultural Department
- ❖ Vocational programs require specialized spaces suited to the specialized curriculum.

Provision and Support Services

- ❖ Food service requires specialized spaces to store, prepare, and serve meals to students.
- ❖ Facilities spaces essential to the districts administration includes:
 - Human Resources
 - Business Office
 - Education Services Department
 - Student Services Department
 - Information Technology
 - Administration meeting and storage spaces
 - Superintendent
 - Food Administration space
 - Instructional Media Center
 - Distribution Center
 - Telecom Services



3 Facilities Inventory

District Facilities Overview

School	Location	Building Area (Sq. Feet)	Core Instructional Spaces	Facility Capacity	Enrollment (2017-2018)	Available Capacity
Slater Elementary School	800 N Fairview Ave. Burns, Oregon 97720	54,356	19	505	429	76
Hines Middle School	500 W. Barnes Ave. Hines, Oregon 97738	44,615	8	280	231	49
Burns High School	1100 Oregon Ave. Burns, Oregon 97720	81,976	10	385	239	146
District Office	550 N. Court Ave. Burns, Oregon 97720	28,374	N/A	N/A	N/A	N/A

HARNEY COUNTY SCHOOL DISTRICT 3

School Inventory

The Harney County School District is centrally located within the two cities of Burns and Hines maintaining (1) elementary school campus, (1) middle school campus, and (1) high school campus as well as a single district office.





SLATER ELEMENTARY SCHOOL

SLATER ELEMENTARY SCHOOL

Facilities Overview

Slater Elementary School is one of two schools within the district sited in Burns, Oregon and oriented in the city's northwest corner. The campus itself houses (2) primary teaching facilities along with (3) external storage spaces and (1) Biomass generator facility. The two primary facilities are split by various playground areas including full-sized basketball courts near the southern end of the campus and a large open grass field to the due directly north of the facilities.

The eastern-most building bearing the "L" shape maintains (13) core grade classrooms for students between kindergarten and 3rd grade as well as a reading room, a life skills classroom, and the special education classroom. The building also houses most of the school's primary administrative and maintenance operations such as the kitchen, cafeteria, school library, IT/Data hub, and (8) primary staff administration/counseling offices including that of the principal.

The smaller western-most facility maintains (6) core grade classrooms from students between 4th and 5th grade as well as housing the school's only gymnasium along with a single staff office. There are (3) external storage buildings on the west-end of campus as well as a Biomass generator. Both primary buildings on campus provide satisfactory access to restrooms for both students and staff along with plenty of open storage space for the school.

As the school is currently sufficient in maintaining their existing enrollment number and is projected to undergo stagnating enrollment fluctuation over the next 21 years, there should be little to no need to address facility expansion. Any sudden and unforeseen large-scale commercial or industrial development changes to the district may require the school the re-visit capacity requirements.



CLASSROOM INVENTORY

SLATER ELEMENTARY SCHOOL						Table 3.1a		
<i>CLASSROOM INVENTORY</i>								
SCHOOL	Grade Level	Current Capacity		Available Capacity		Number Of Classrooms	Over-Capacity Risk	
Slater Elementary School	Kindergarten	89	119%	(- 14)	- 19%	3	LOW	
	1 st Grade	65	65%	35	35%	4		
	2 nd Grade	64	85%	11	15%	3		
	3 rd Grade	73	97%	2	3%	3		
	4 th Grade	72	80%	18	20%	3		
	5 th Grade	66	73%	24	27%	3		
	Total Instructional Spaces:				25		Total Elementary Students:	429
	Adjusted Core Occupied Instructional Spaces:				19		Elementary School Capacity:	505
	Instructional Space Sq. Footage: 7,469 sq. ft Core Occupied Instructional Sq. Footage: 17,996 sq. ft							



CLASSROOM INVENTORY

Room Number	Classroom / Educational Space	Building Number	Occupied Area (sq. footage)	Type
20	Kindergarten Classroom	1	962 sq. ft	Core Classroom
21	Kindergarten Classroom	1	1,021 sq. ft	Core Classroom
23	Kindergarten Classroom	1	987 sq. ft	Core Classroom
4	1 st Grade Classroom	1	823 sq. ft	Core Classroom
5	1 st Grade Classroom	1	829 sq. ft	Core Classroom
6	1 st Grade Classroom	1	822 sq. ft	Core Classroom
10	1 st Grade Classroom	1	829 sq. ft	Core Classroom
15	2 nd Grade Classroom	1	1,025 sq. ft	Core Classroom
17	2 nd Grade Classroom	1	988 sq. ft	Core Classroom
19	2 nd Grade Classroom	1	1,016 sq. ft	Core Classroom
14	3 rd Grade Classroom	1	838 sq. ft	Core Classroom
16	3 rd Grade Classroom	1	979 sq. ft	Core Classroom
18	3 rd Grade Classroom	1	979 sq. ft	Core Classroom
26	4 th Grade Classroom	2	1,014 sq. ft	Core Classroom
28	4 th Grade Classroom	2	1,021 sq. ft	Core Classroom
29	4 th Grade Classroom	2	1,009 sq. ft	Core Classroom
24	5 th Grade Classroom	2	1,020 sq. ft	Core Classroom
25	5 th Grade Classroom	2	1,025 sq. ft	Core Classroom
27	5 th Grade Classroom	2	809 sq. ft	Core Classroom
7	Computer Lab	1	822 sq. ft	Educational Space
8	Special Education Classroom	1	651 sq. ft	Educational Space
22	Reading Room	1	961 sq. ft	Educational Space
-	Life Skills Classroom	1	1,019 sq. ft	Educational Space
-	Library	1	1,113 sq. ft	Educational Space
-	Gymnasium	2	4,626 sq. ft	Educational Space
-	Stage	2	739 sq. ft	Educational Space



CLASSROOM INVENTORY

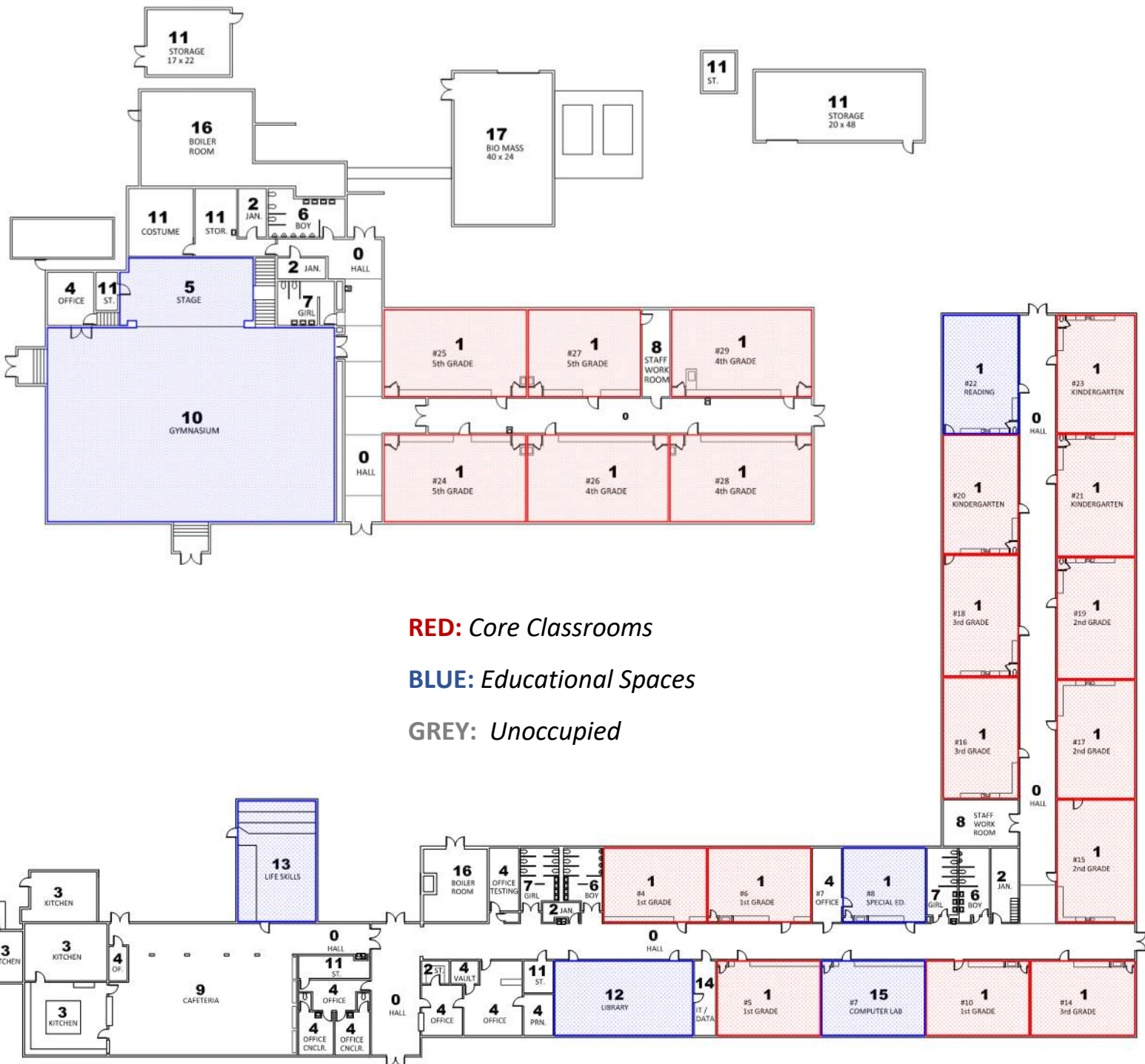



ADMINISTRATIVE & MAINTENANCE INVENTORY

SLATER ELEMENTARY SCHOOL

ADMINISTRATIVE & MAINTENANCE INVENTORY

Table 3.1b

Space	Occupied Area (sq. footage)	Map Number	Building Number
Janitorial Office 1	79 sq. ft	2	1
Janitorial Office 2	219 sq. ft	2	1
Janitorial Office 3	112 sq. ft	2	2
Janitorial Office 4	84 sq. ft	2	2
Kitchen Space 1	366 sq. ft	3	1
Kitchen Space 2	189 sq. ft	3	1
Kitchen Space 3	506 sq. ft	3	1
Kitchen Space 4	647 sq. ft	3	1
Office 1 (Kitchen Office)	68 sq. ft	4	1
Office 2	177 sq. ft	4	1
Office 3	221 sq. ft	4	1
Office 4	427 sq. ft	4	1
Office 5 / Testing Room	202 sq. ft	4	1
Office 6	233 sq. ft	4	1
Office 7 (Gym Office)	203 sq. ft	4	2
Counseling Office 1	162 sq. ft	4	1
Counseling Office 2	162 sq. ft	4	1
Principal's Office	131 sq. ft	4	1
Staff Work Room 1	374 sq. ft	8	1
Staff Work Room 2	200 sq. ft	8	2
Cafeteria	2,654 sq. ft	9	1
IT / Data Room	172 sq. ft	14	1
Boiler Room 1	498 sq. ft	16	1
Boiler Room 2	1,094 sq. ft	16	2
Bio Mass Building	1,240 sq. ft	17	2
Total Administration Sq. Footage: 6,922 sq. ft			
Total Maintenance Sq. Footage: 3,498 sq. ft			



ADMINISTRATIVE & MAINTENANCE INVENTORY

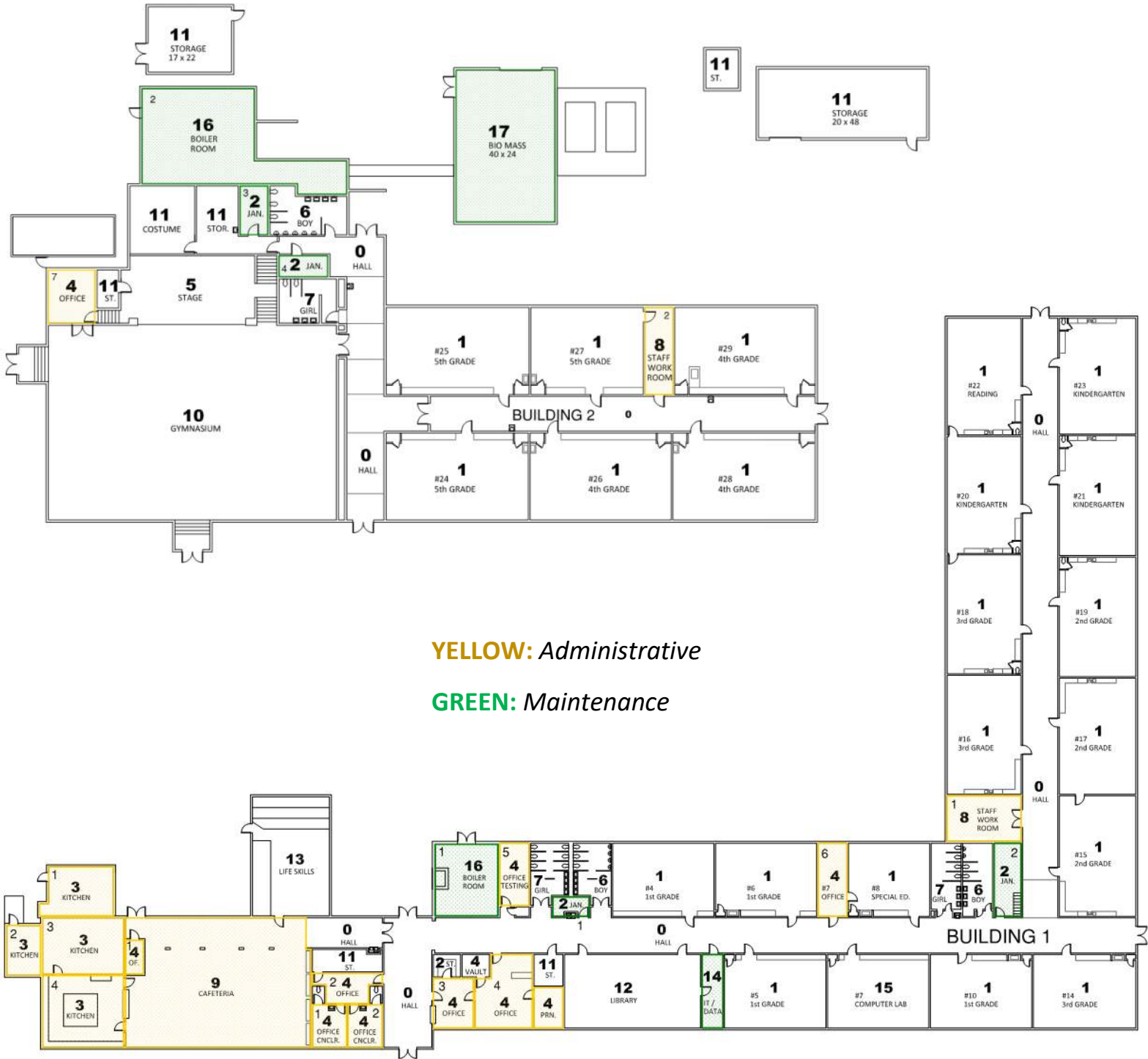

YELLOW: Administrative

GREEN: Maintenance



STORAGE INVENTORY

SLATER ELEMENTARY SCHOOL		Table 3.1c	
<u>STORAGE INVENTORY</u>			
Space	Occupied Area (sq. footage)	Map Number	Building Number
Janitorial Storage	68 sq. ft	2	1
Office Vault	69 sq. ft	4	1
Storage Room 1 (Office Storage)	168 sq. ft	11	1
Storage Room 2 (Hallway Storage)	102 sq. ft	11	1
Storage Room 3 (Stage Storage)	68 sq. ft	11	2
Storage Room 4 (Stage Storage)	290 sq. ft	11	2
Storage Room 5 (External Building)	448 sq. ft	11	2
Storage Room 6 (External Building)	103 sq. ft	11	2
Storage Room 7 (External Building)	957 sq. ft	11	2
Costume Storage	363 sq. ft	11	2
Total Storage Sq. Footage: 2,636 sq. ft			



STORAGE INVENTORY

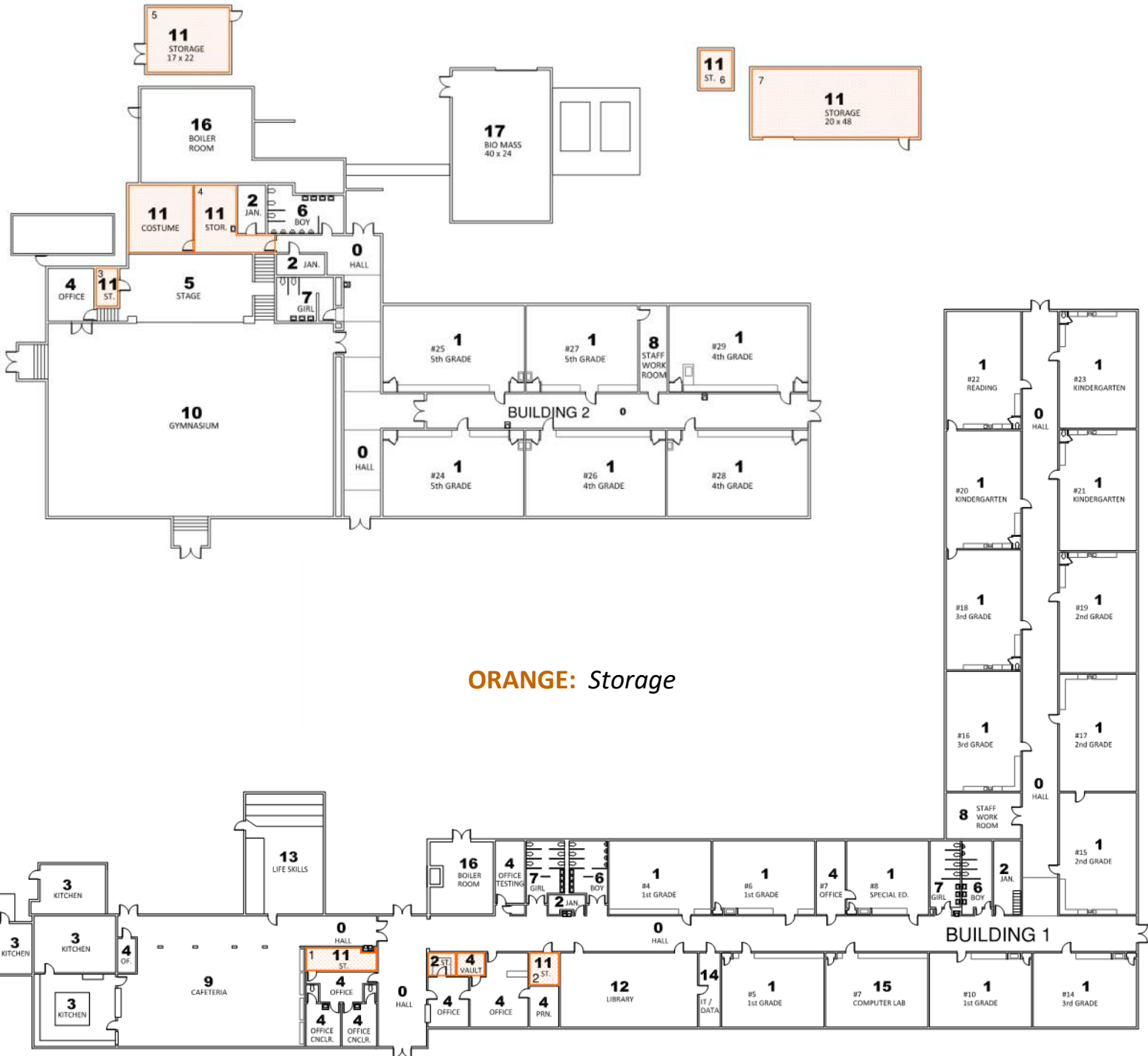

ORANGE: Storage



BATHROOM INVENTORY

SLATER ELEMENTARY SCHOOL			Table 3.1d
<i>BATHROOM INVENTORY</i>			
Space	Occupied Area (sq. footage)	Bathroom Type	ADA Compliance
Counseling Office Bathroom 1	23 sq. ft	Single Use	Unsatisfactory
Counseling Office Bathroom 2	23 sq. ft	Single Use	Unsatisfactory
Girls Bathroom 1	242 sq. ft	Communal	Satisfactory
Boys Bathroom 1	242 sq. ft	Communal	Satisfactory
Girls Bathroom 2	220 sq. ft	Communal	Satisfactory
Boys Bathroom 2	229 sq. ft	Communal	Satisfactory
Girls Bathroom 3	203 sq. ft	Communal	Satisfactory
Boys Bathroom 3	264 sq. ft	Communal	Satisfactory
Total Bathrooms: 8		ADA Compliant: 6 Bathrooms	
Total Bathroom Sq. Footage: 1,446 sq. ft		ADA Uncompliant: 2 Bathrooms	



BATHROOM INVENTORY





HINES MIDDLE SCHOOL

HINES MIDDLE SCHOOL

Facilities Overview

Hines Middle School is the only within the district located in Hines, Oregon oriented due northwest of the city's center. The campus overall houses a single 2-story facility along with a large grass field to its southeast and (3) full-sized basketball courts to its south.

The lower level of the facility contains both the school's science and language arts classrooms (core studies) along with an art, leadership, and speech classroom, totaling (7) classrooms. The lower floor also maintains the school's only cafeteria and kitchen along with (4) maintenance rooms and a laundry room. As for storage, the lower floor contains (3) smaller storage rooms / closets along with (2) larger storage rooms oriented across from the science classroom.

The upper level of the facility contains both the school's math and social studies classrooms, as well as home economics, careers, and band classrooms. The upper level also maintains the schools only special education classrooms and full-sized gymnasium complete with a stage. Administratively, all the school's offices are located on the upper level including the main office and that of the principals. As for school maintenance, the upper level only has (2) janitorial closets. Storage-wise, the upper level maintains a total of (5) spaces ranging from office storage to gymnasium storage.

Both levels provide sufficient access to restrooms as well as locker rooms for both boys and girls near the gymnasium on the upper level. As for resources not provided, the facility seems to be lacking a designated area for a school library or reading area.

As the school is currently sufficient in maintaining their existing enrollment number and is projected to undergo stagnating enrollment fluctuation over the next 21 years, there should be little to no need to address facility expansion. Any sudden and unforeseen large-scale commercial or industrial development changes to the district may require the school the re-visit capacity requirements.



CLASSROOM INVENTORY

HINES MIDDLE SCHOOL				Table 3.2a			
<i>CLASSROOM INVENTORY</i>							
SCHOOL	Grade Level	Current Capacity	Available Capacity		Over-Capacity Risk		
Hines Middle School	6 th Grade	87	83%	49	17%	LOW	
	7 th Grade	66					
	8 th Grade	78					
	Total Instructional Spaces:			19		Total Elementary Students:	231
	Adjusted Core Occupied Instructional Spaces:			8		Elementary School Capacity:	280
	Instructional Space Sq. Footage: Core Occupied Instructional Sq. Footage:						



CLASSROOM INVENTORY

Room Number	Classroom / Educational Space	Floor	Occupied Area (sq. footage)	Type
1	Special Education Classroom	Upper	790 sq. ft	Educational Space
2, 4	Library	Upper	1,136 sq. ft	Educational Space
6	Special Education Classroom	Upper	561 sq. ft	Educational Space
10	Math / Social Studies Classroom	Upper	877 sq. ft	Core Classroom
11	Math Classroom	Upper	931 sq. ft	Core Classroom
12	Computer Lab	Upper	847 sq. ft	Educational Space
13	Social Studies Classroom	Upper	931 sq. ft	Core Classroom
15	Home Economics Classroom	Upper	970 sq. ft	Educational Space
16	Computers, Agriculture, & Careers Classroom	Upper	913 sq. ft	Educational Space
17	Math / Health Classroom	Upper	893 sq. ft	Core Classroom
33, 35	Band / Choir Room	Upper	1,541 sq. ft	Educational Space
-	Gymnasium	Upper	5,501 sq. ft	Educational Space
-	Stage	Upper	437 sq. ft	Educational Space
3	Speech Classroom	Lower	213 sq. ft	Educational Space
21	Science Classroom	Lower	927 sq. ft	Core Classroom
23	Science / S.T.E.M Classroom	Lower	902 sq. ft	Core Classroom
25	Leadership Classroom	Lower	902 sq. ft	Educational Space
26	Language Arts / Drama Classroom	Lower	922 sq. ft	Core Classroom
27	Language Arts Classroom	Lower	927 sq. ft	Core Classroom
28	Arts & Crafts Classroom	Lower	927 sq. ft	Educational Space



CLASSROOM INVENTORY

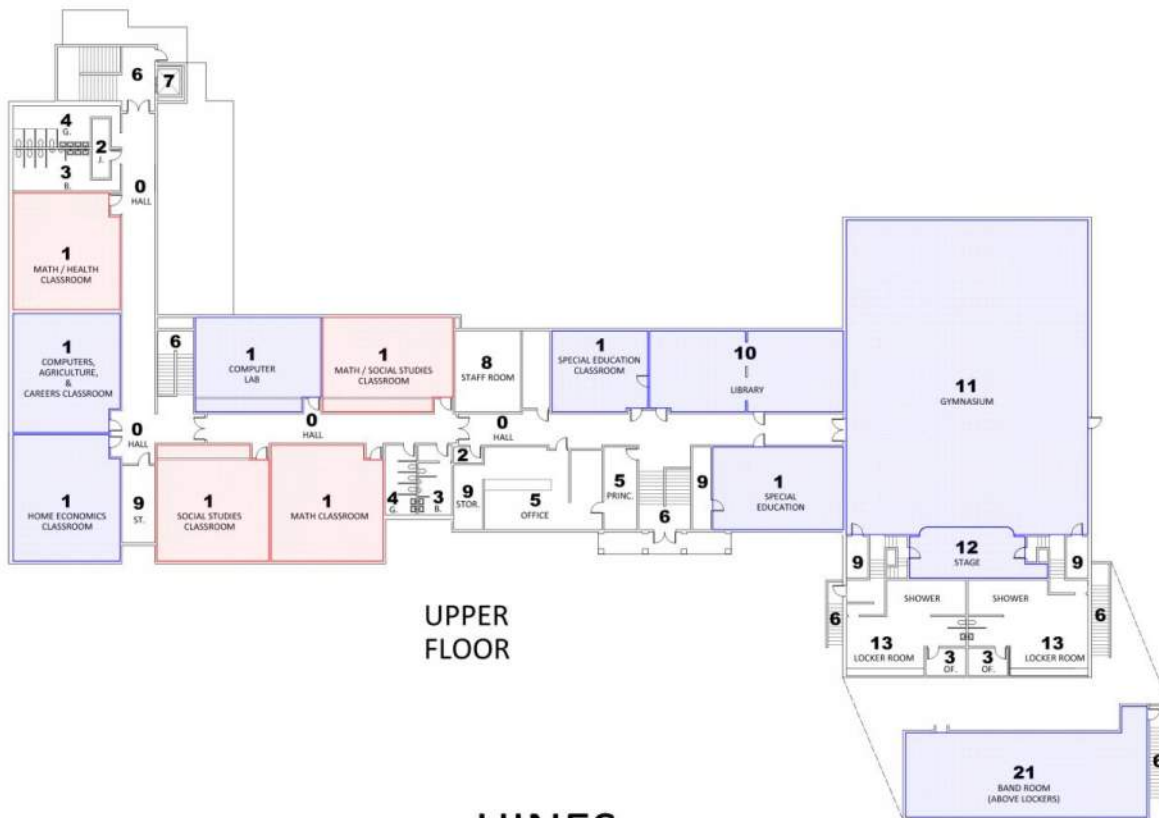

UPPER FLOOR

HINES MIDDLE SCHOOL

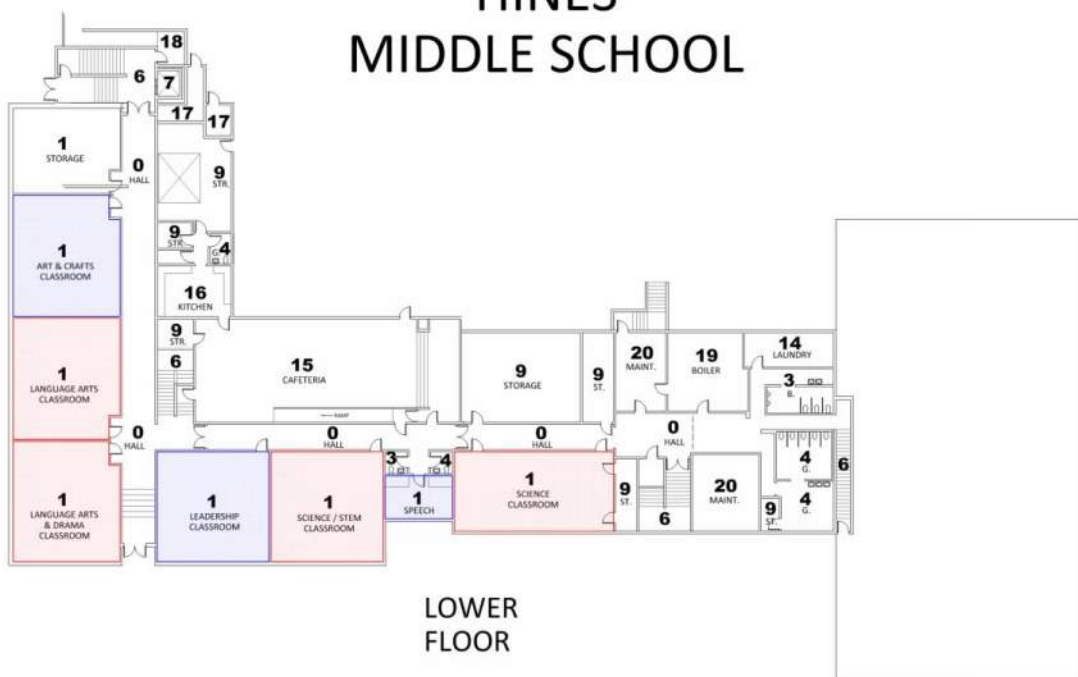

LOWER FLOOR



ADMINISTRATIVE & MAINTENANCE INVENTORY

HINES MIDDLE SCHOOL

ADMINISTRATIVE & MAINTENANCE INVENTORY

Table 3.2b

Occupied Space	Occupied Area (sq. footage)	Floor	Type
Principal's Office	200 sq. ft	Upper	Administrative
Main Office	688 sq. ft	Upper	Administrative
Boys Locker Room Office	81 sq. ft	Upper	Administrative
Girls Locker Room Office	81 sq. ft	Upper	Administrative
Janitorial Closet	34 sq. ft	Upper	Maintenance
Janitorial Closet (Boys Bathroom)	75 sq. ft	Upper	Maintenance
Kitchen	274 sq. ft	Lower	Administrative
Cafeteria	1,989 sq. ft	Lower	Administrative
Laundry Room	223 sq. ft	Lower	Administrative
Maintenance Room 1	100 sq. ft	Lower	Maintenance
Maintenance Room 2	57 sq. ft	Lower	Maintenance
Maintenance Room 3	289 sq. ft	Lower	Maintenance
Maintenance Room 4	374 sq. ft	Lower	Maintenance
Boiler Room	445 sq. ft	Lower	Maintenance



ADMINISTRATIVE & MAINTENANCE INVENTORY

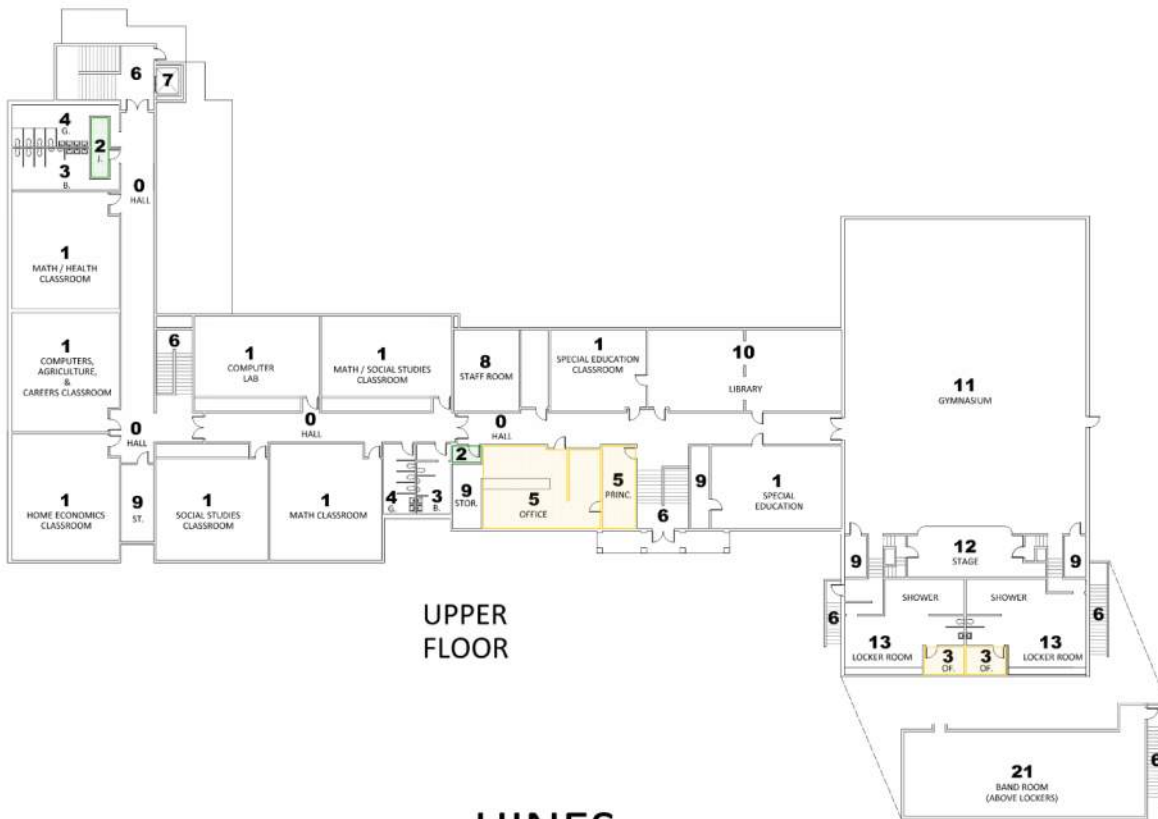

HINES MIDDLE SCHOOL

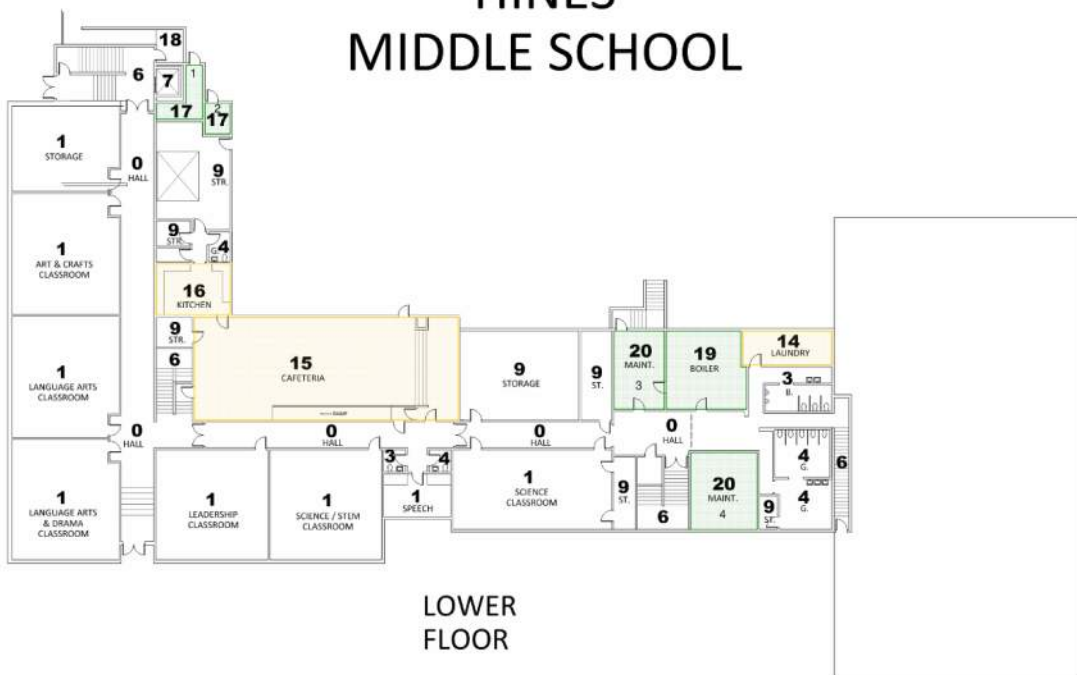



STORAGE INVENTORY

HINES MIDDLE SCHOOL		Table 3.2b	
<u>STORAGE INVENTORY</u>			
Space	Occupied Area (sq. footage)	Floor	
Storage Room 1 (Room 14)	187 sq. ft	Upper	
Main Office Storage Room	137 sq. ft	Upper	
Special Education Storage Room	112 sq. ft	Upper	
Gymnasium Storage 1	66 sq. ft	Upper	
Gymnasium Storage 2	66 sq. ft	Upper	
Storage Room 2 (Room 22)	777 sq. ft	Lower	
Storage Room 3	205 sq. ft	Lower	
Science Classroom Storage	114 sq. ft	Lower	
Kitchen Storage Room 1	523 sq. ft	Lower	
Kitchen Storage Room 2	64 sq. ft	Lower	
Cafeteria Storage Room	77 sq. ft	Lower	
Girls Bathroom Storage Room	45 sq. ft	Lower	
Total Storage Sq. Footage:			



STORAGE INVENTORY

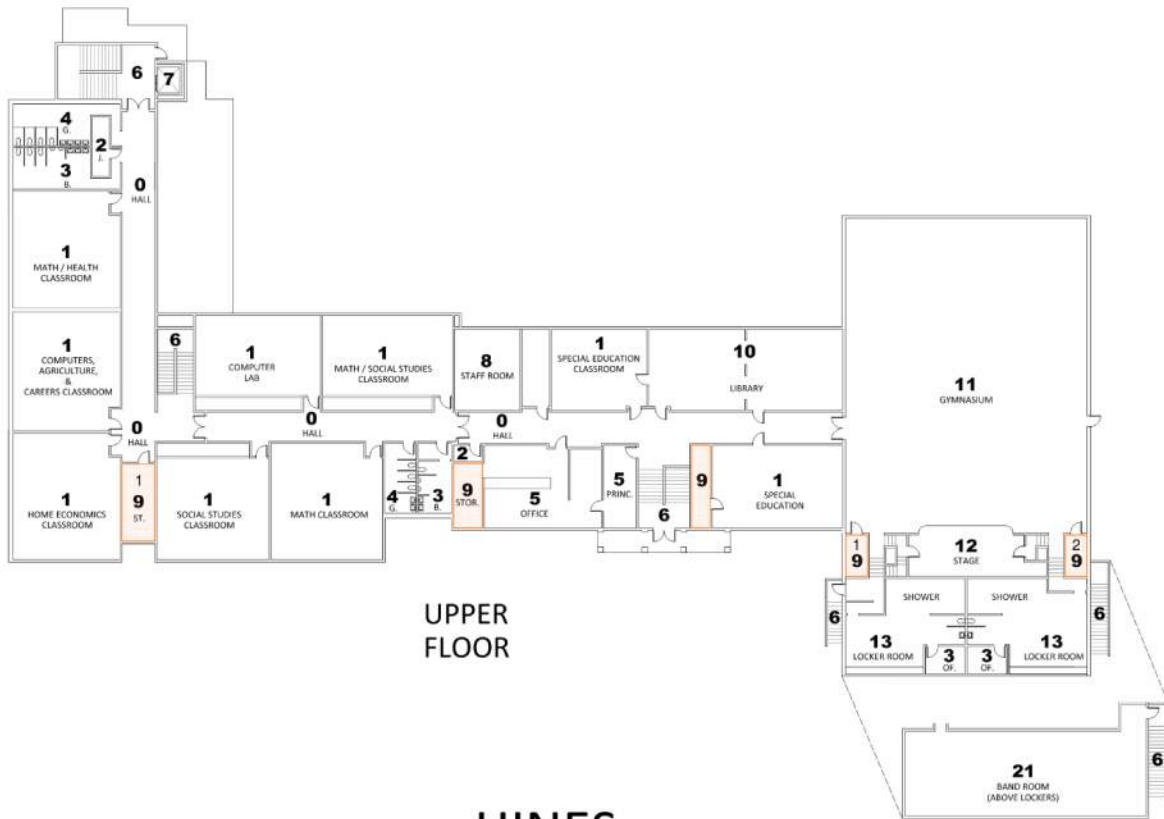

HINES MIDDLE SCHOOL

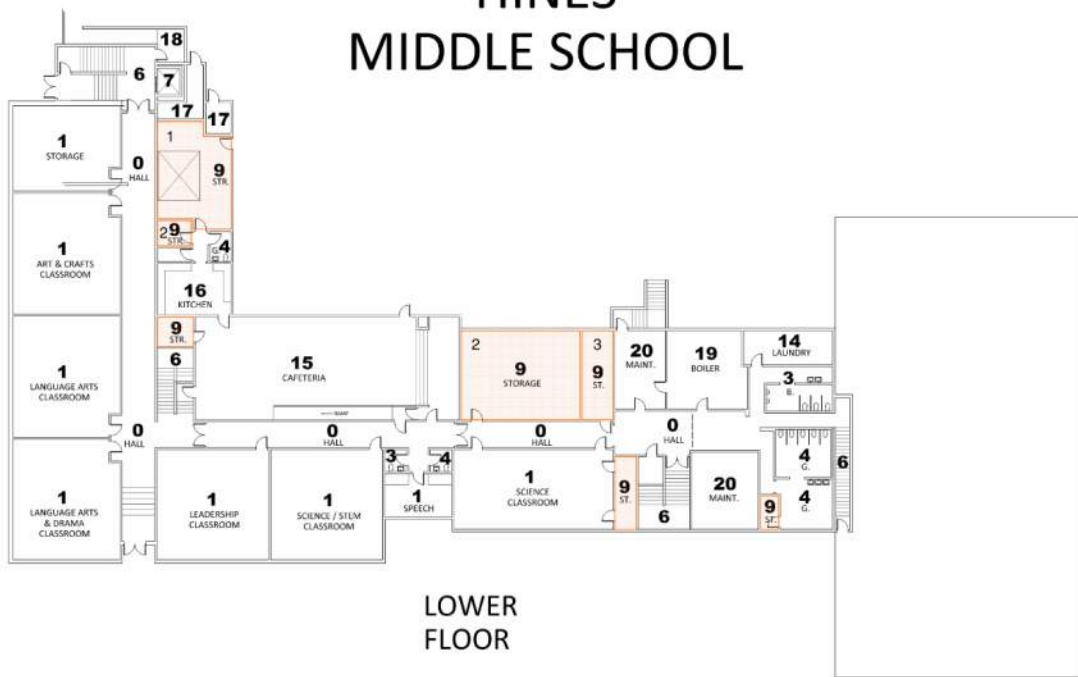



BATHROOM INVENTORY

HINES MIDDLE SCHOOL		Table 3.2d	
<u>BATHROOM INVENTORY</u>			
Bathroom	Occupied Area (sq. footage)	Bathroom Type	ADA Compliance
Girls Bathroom 1 (Upper)	279 sq. ft	Communal	Satisfactory
Girls Bathroom 2 (Upper)	160 sq. ft	Communal	Satisfactory
Girls Locker Room	702 sq. ft	Communal	Satisfactory
Boys Bathroom 1 (Upper)	279 sq. ft	Communal	Satisfactory
Boys Bathroom 2 (Upper)	172 sq. ft	Communal	Satisfactory
Boys Locker Room	667 sq. ft	Communal	Satisfactory
Girls Bathroom 3 (Lower)	393 sq. ft	Communal	Satisfactory
Girls Bathroom (Speech Classroom)	36 sq. ft	Single Use	Satisfactory
Girls Bathroom (Kitchen)	47 sq. ft	Single Use	Satisfactory
Boys Bathroom 3 (Lower)	192 sq. ft	Communal	Satisfactory
Boys Bathroom (Speech Classroom)	36 sq. ft	Single Use	Satisfactory
Total Bathrooms: 11		ADA Compliant: 11 Bathrooms	
Total Bathroom Sq. Footage:		ADA Uncompliant: 0 Bathrooms	



BATHROOM INVENTORY

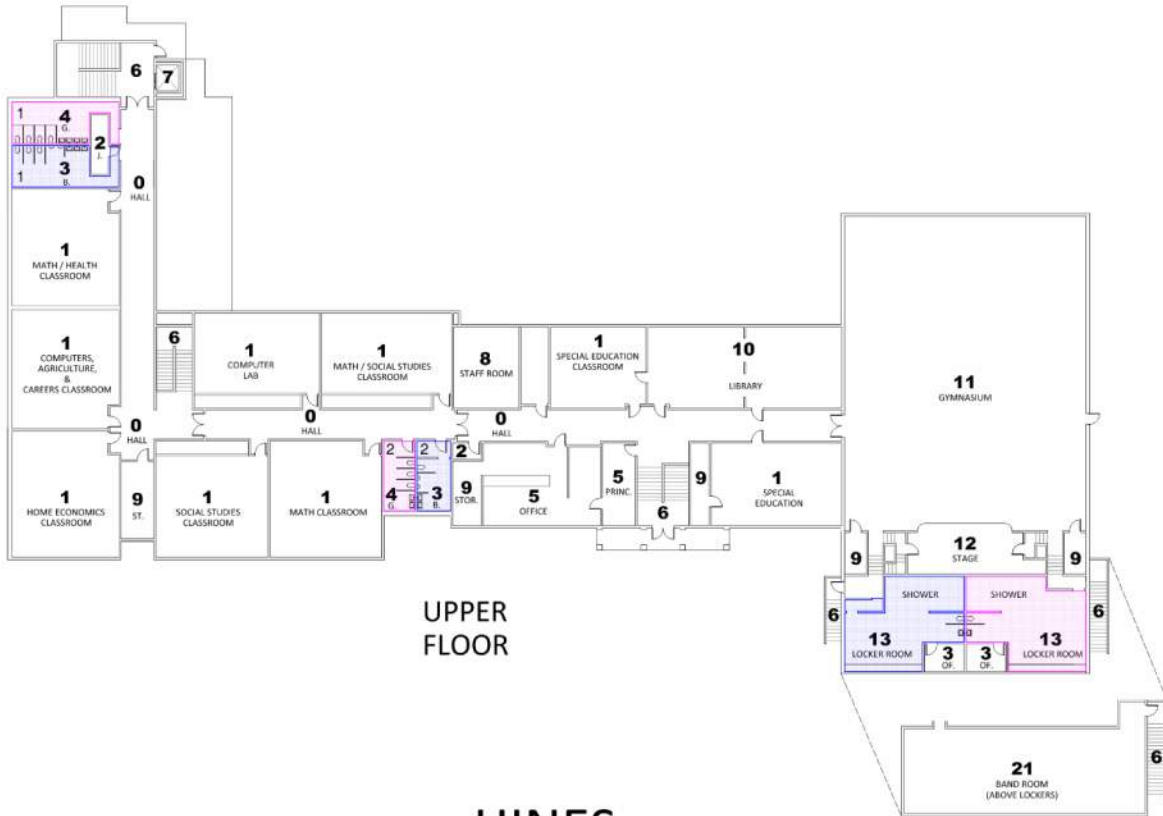

HINES MIDDLE SCHOOL

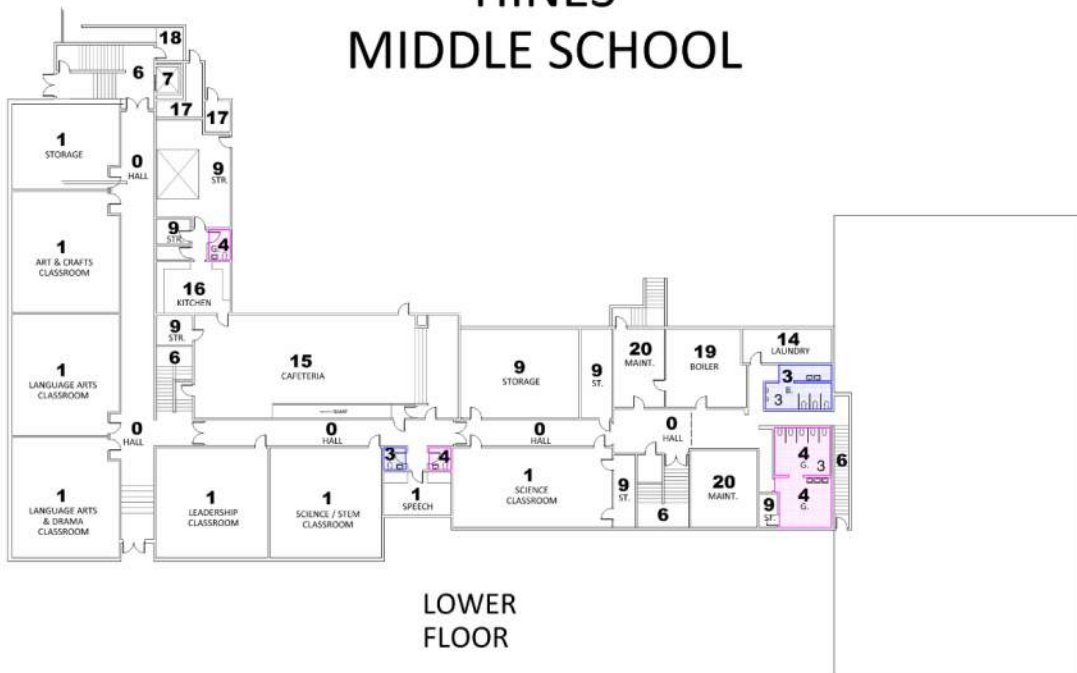



BURNS HIGH SCHOOL

BURNS HIGH SCHOOL

Facilities Overview

Burns High School is one of two schools within the district located in Burns, Oregon oriented near the very southern end of town. The campus itself maintains a large single-story facility as well as (3) smaller buildings on the north end of campus including a metals shop, an automotive shop, and a boiler shed and (2) structures west of the main building acting as maintenance buildings. Just west of the facility lies the track and football field, along with one of the school's baseball diamonds. The second baseball diamond is located just due north of the smaller (3) buildings.

The school itself maintains a total of (21) classrooms, (10) of which represent core studies and (2) which act as the school's special education classrooms. The facility also contains a full-sized gymnasium, a library, a weight room, (2) computer labs, and (2) greenhouses.

The school's administration and offices are centrally located on the eastern end of the facility including the vice-principal's, principal's, and main office. The school's cafeteria and kitchen are located on the western end of the facility providing all necessary culinary accommodations.

As for maintenance, the school maintains a single information technology center, (3) janitorial closets, a laundry room, and a boiler room.

As for storage, the school contains a total of (9) rooms, (2) of which are previous classrooms along with a vault located near the main office.

Bathroom access is sufficient in covering the entirety of the facility with (4) public girls' bathrooms and (4) public boys' bathrooms as well as (2) full locker rooms located near the gymnasium.

As the school is currently sufficient in maintaining their existing enrollment number and is projected to undergo stagnating enrollment fluctuation over the next 21 years, there should be little to no need to address facility expansion. Any sudden and unforeseen large-scale commercial or industrial development changes to the district may require the school the re-visit capacity requirements.



CLASSROOM INVENTORY

BURNS HIGH SCHOOL				Table 3.3a			
<u>CLASSROOM INVENTORY</u>							
SCHOOL	Grade Level	Current Capacity	Available Capacity		Over-Capacity Risk		
Burns High School	9 th Grade	55	62%	146	38%	LOW	
	10 th Grade	67					
	11 th Grade	53					
	12 th Grade	64					
	Total Instructional Spaces:			32		Total Students:	239
	Adjusted Core Occupied Instructional Spaces:			10		School Capacity:	385
	Instructional Space Sq. Footage: Core Occupied Instructional Sq. Footage:						

3 Facilities Inventory



CLASSROOM INVENTORY

Room Number	Classroom / Educational Space	Occupied Area (sq. footage)	Type
14	Special Education Classroom	958 sq. ft	Educational Space
15	FFA / Agriculture Classroom	949 sq. ft	Educational Space
16	Science Classroom	1,459 sq. ft	Core Classroom
17	Fine Arts Classroom	1,478 sq. ft	Educational Space
18	Credit Retrieval Classroom	1,065 sq. ft	Educational Space
19	Special Education Classroom / Independent Learning Skills	1,276 sq. ft	Educational Space
22	Computer Lab	846 sq. ft	Educational Space
23	Leadership Classroom	846 sq. ft	Educational Space
24	English Classroom	846 sq. ft	Core Classroom
25	Spanish Classroom	846 sq. ft	Core Classroom
26	Math Classroom	846 sq. ft	Core Classroom
27	English Classroom	846 sq. ft	Core Classroom
28	Math Classroom	843 sq. ft	Core Classroom
29	Social Studies Classroom	843 sq. ft	Core Classroom
33	Health Classroom	1,048 sq. ft	Core Classroom
34	Computer Lab	1,051 sq. ft	Educational Space
35	Social Studies Classroom	1,051 sq. ft	Core Classroom
37	Science Classroom	1,281 sq. ft	Core Classroom
38	Vocational Classroom	1,227 sq. ft	Educational Space
39	Band / Choir Classroom	3,407 sq. ft	Educational Space
-	Library	1,941 sq. ft	Educational Space
-	Book Room	247 sq. ft	Educational Space
-	Speech Classroom	156 sq. ft	Core Classroom
40	Gymnasium	9,722 sq. ft	Educational Space
-	Stage	1,232 sq. ft	Educational Space
45	Wood Shop	2,046 sq. ft	Educational Space
46	Weight Room	1,467 sq. ft	Educational Space
50	Ceramics Classroom	1,122 sq. ft	Educational Space
51	Metals Shop	3,343 sq. ft	Educational Space
52	Automotive Shop	3,846 sq. ft	Educational Space
-	Greenhouse 1	957 sq. ft	Educational Space
-	Greenhouse 2	957 sq. ft	Educational Space

3 Facilities Inventory



CLASSROOM INVENTORY

RED: Core Classrooms

BLUE: Educational Spaces

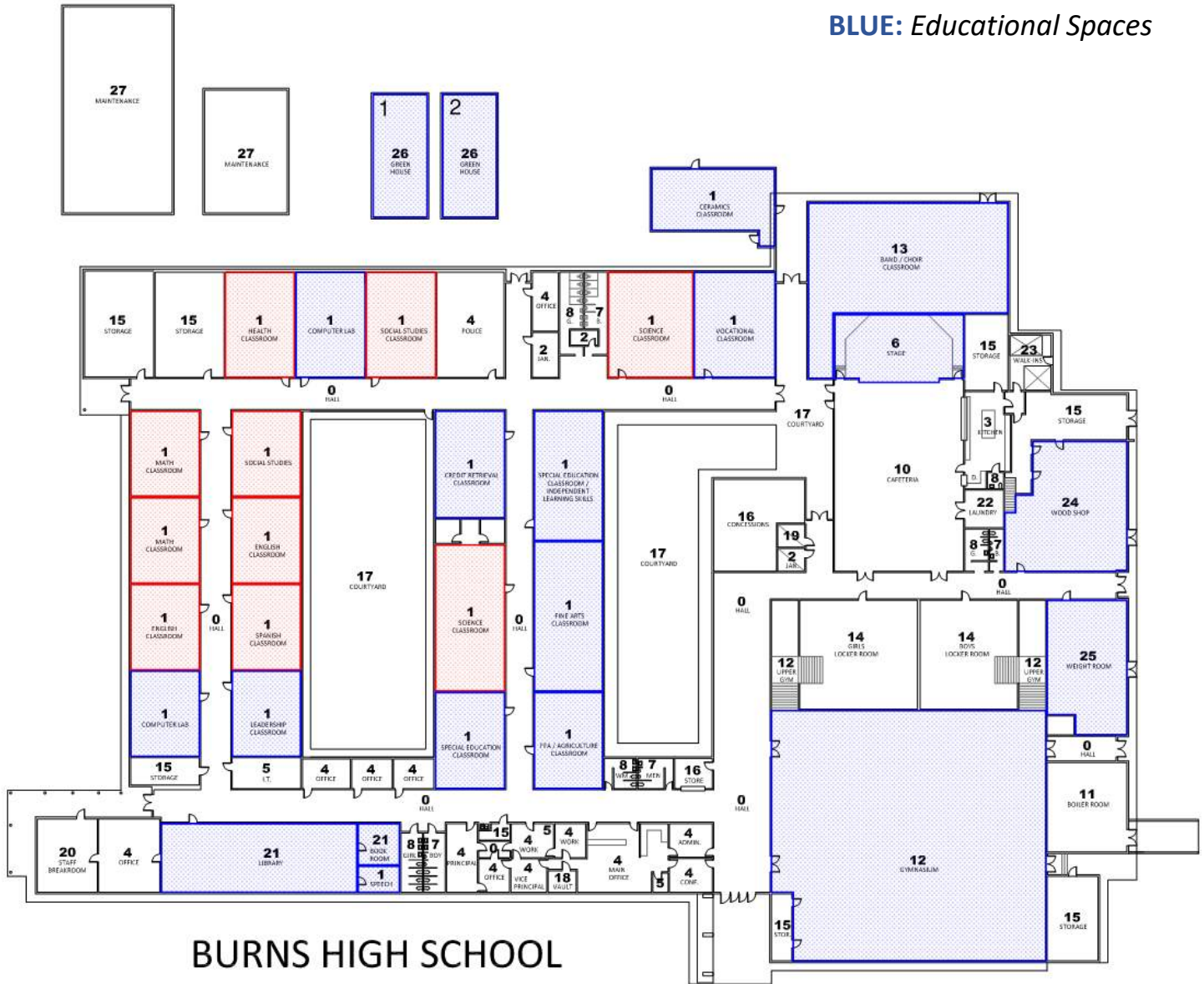

Core Instructional Sq. Footage: 10,065 sq. ft

Educational Space Sq. Footage: 32,794 sq. ft



CLASSROOM INVENTORY

RED: Core Classrooms

BLUE: Educational Spaces

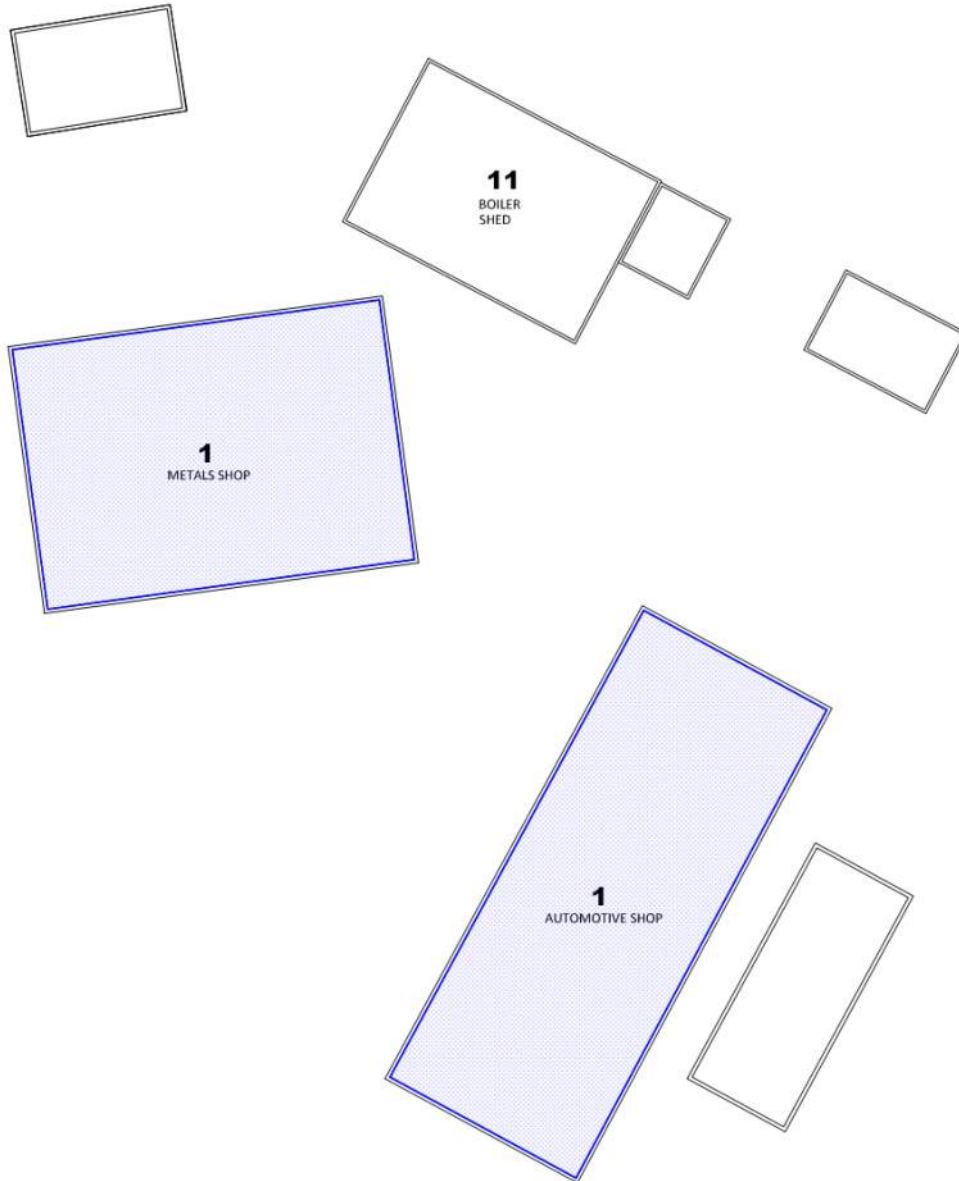

Core Instructional Sq. Footage: N/A

Educational Space Sq. Footage: 7,189 sq. ft



ADMINISTRATIVE & MAINTENANCE INVENTORY

BURNS HIGH SCHOOL

ADMINISTRATION & MAINTENANCE INVENTORY

Table 3.3b

Occupied Space	Occupied Area (sq. footage)	Type
Office Space 1	205 sq. ft	Administrative
Office Space 2	173 sq. ft	Administrative
Office Space 3	173 sq. ft	Administrative
Office Space 4	649 sq. ft	Administrative
Office Space 5	149 sq. ft	Administrative
Office Space 6	221 sq. ft	Administrative
Main Office	838 sq. ft	Administrative
Vice Principal's Office	173 sq. ft	Administrative
Principal's Office	306 sq. ft	Administrative
Work Room 1	208 sq. ft	Administrative
Work Room 2	152 sq. ft	Administrative
Staff Breakroom	636 sq. ft	Administrative
Administration Space	208 sq. ft	Administrative
Conference Room	210 sq. ft	Administrative
Cafeteria	3,548 sq. ft	Administrative
Kitchen	554 sq. ft	Administrative
Walk-In Coolers	329 sq. ft	Administrative
Concessions	1,013 sq. ft	Administrative
School Store	164 sq. ft	Administrative
Police Office	1,021 sq. ft	Maintenance
Information Technology Office	306 sq. ft	Maintenance
Information Technology Hub	43 sq. ft	Maintenance
Janitorial Office	169 sq. ft	Maintenance
Janitorial Closet	89 sq. ft	Maintenance
Janitorial Closet (Bathroom)	59 sq. ft	Maintenance
Mechanical / Electrical Room	89 sq. ft	Maintenance
Laundry Room	211 sq. ft	Maintenance
Boiler Room	1,029 sq. ft	Maintenance
Boiler Shed	1,592 sq. ft	Maintenance
Maintenance Shop 1	3,238 sq. ft	Maintenance
Maintenance Shop 2	1,467 sq. ft	Maintenance

3 Facilities Inventory



ADMINISTRATIVE & MAINTENANCE INVENTORY

YELLOW: Administrative

GREEN: Maintenance

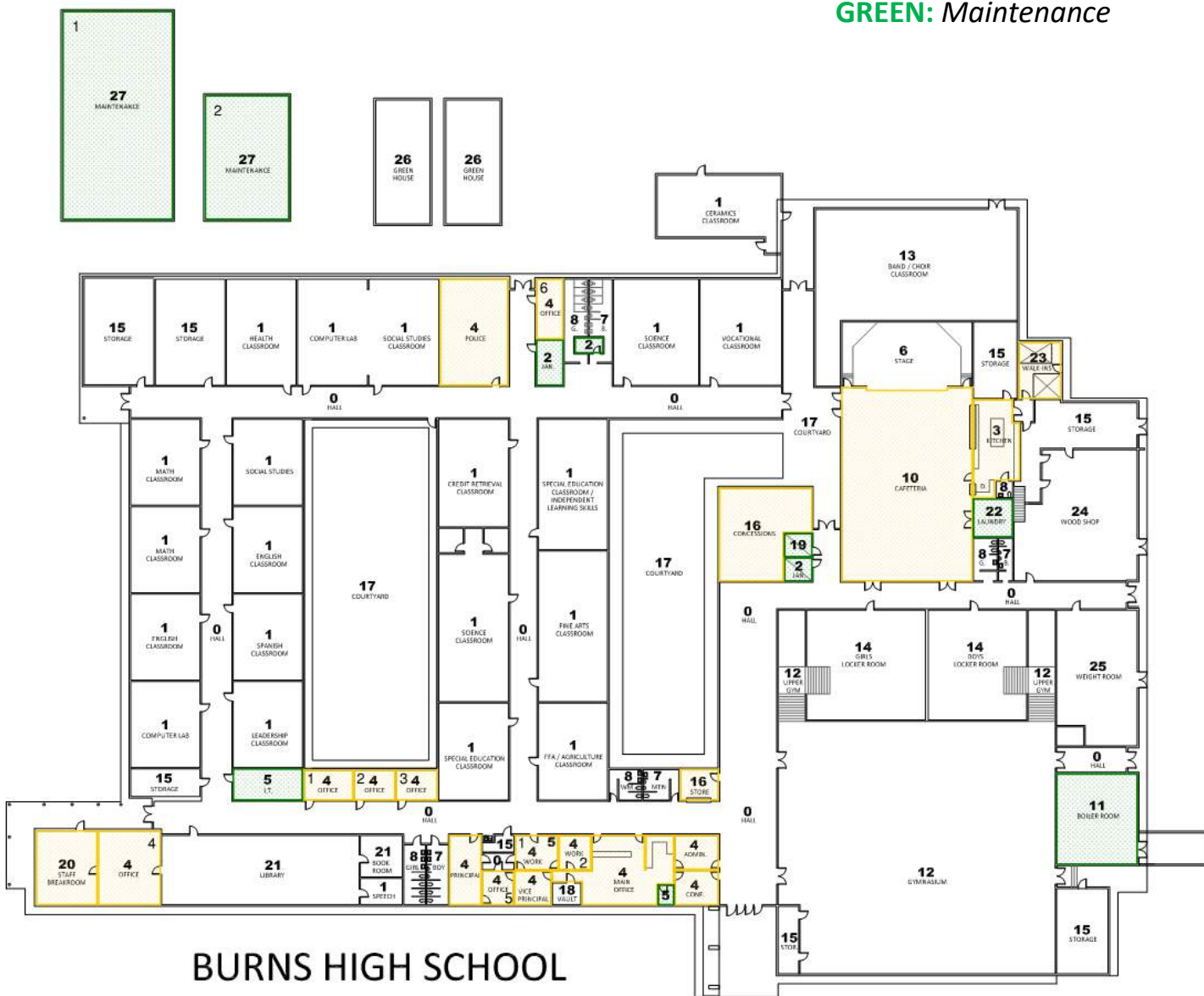

Administrative Sq. Footage: 9,909 sq. ft

Maintenance Sq. Footage: 7,721 sq. ft



ADMINISTRATION & MAINTENANCE INVENTORY

YELLOW: Administrative

GREEN: Maintenance

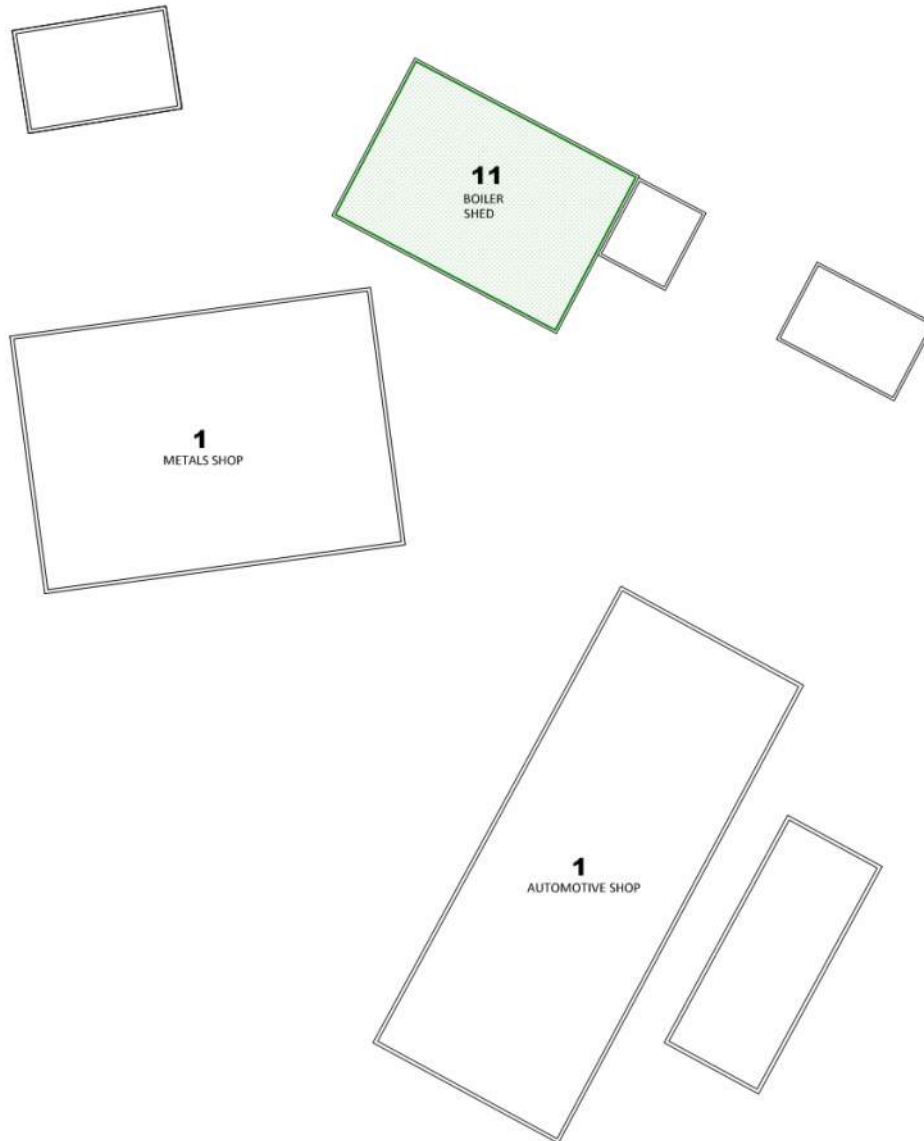

Administrative Sq. Footage: N/A

Maintenance Sq. Footage: 1,592 sq. ft



STORAGE INVENTORY

BURNS HIGH SCHOOL
STORAGE INVENTORY

Table 3.3c

Storage Space	Occupied Area (sq. footage)
Storage Room 1	272 sq. ft
Storage Room 2	1,062 sq. ft
Storage Room 3	1,048 sq. ft
Storage Room 4	620 sq. ft
Kitchen Storage	472 sq. ft
Wood Shop Storage	889 sq. ft
Gym Storage	197 sq. ft
Administrative Vault	87 sq. ft
Administrative Storage Closet	61 sq. ft

3 Facilities Inventory



STORAGE INVENTORY

ORANGE: Storage

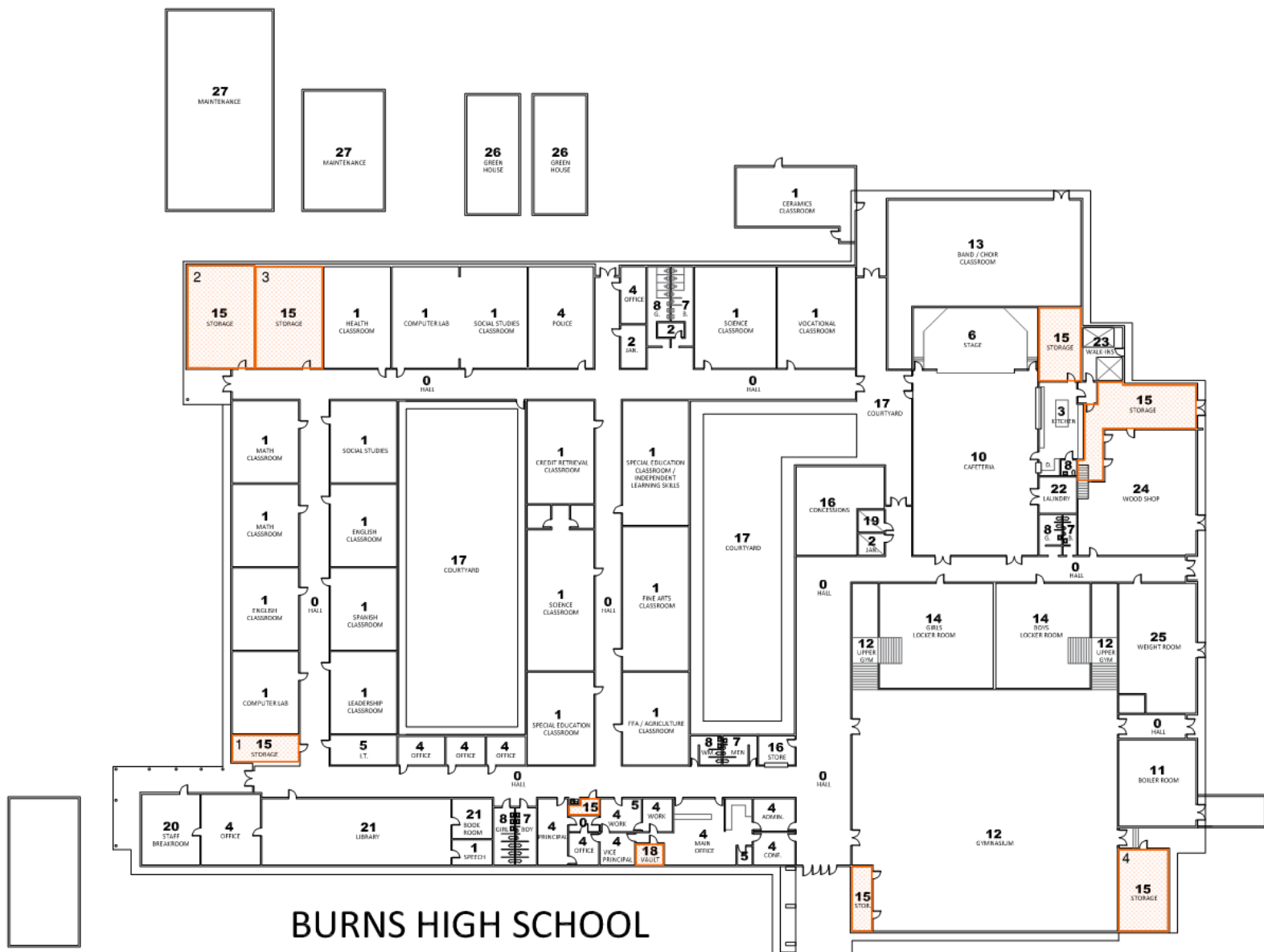

Storage Sq. Footage: 4,708 sq. ft



BATHROOM INVENTORY

BURNS HIGH SCHOOL BATHROOM INVENTORY

Table 3.3d

Bathroom	Occupied Area (sq. footage)	Bathroom Type	ADA Compliance
Girls Bathroom (Main Offices)	184 sq. ft	Communal	Satisfactory
Boys Bathroom (Main Offices)	184 sq. ft	Communal	Satisfactory
Girls Bathroom (School Store)	136 sq. ft	Communal	Satisfactory
Boys Bathroom (School Store)	150 sq. ft	Communal	Satisfactory
Girls Locker Room	1,850 sq. ft	Communal	Satisfactory
Boys Locker Room	1,533 sq. ft	Communal	Satisfactory
Girls Bathroom (Cafeteria)	139 sq. ft	Communal	Satisfactory
Boys Bathroom (Cafeteria)	84 sq. ft	Communal	Satisfactory
Girls Bathroom (Main Classrooms)	243 sq. ft	Communal	Satisfactory
Boys Bathroom (Main Classrooms)	234 sq. ft	Communal	Satisfactory
Unisex Bathroom (Kitchen)	38 sq. ft	Single Use	Satisfactory
Total Bathrooms: 11		ADA Compliant: 11 Bathrooms	
Total Bathroom Sq. Footage: 4,775 sq. ft		ADA Noncompliant: 0 Bathrooms	



BATHROOM INVENTORY

BLUE: Boys Bathroom

PINK: Girls Bathroom

TEAL: Single User Bathroom

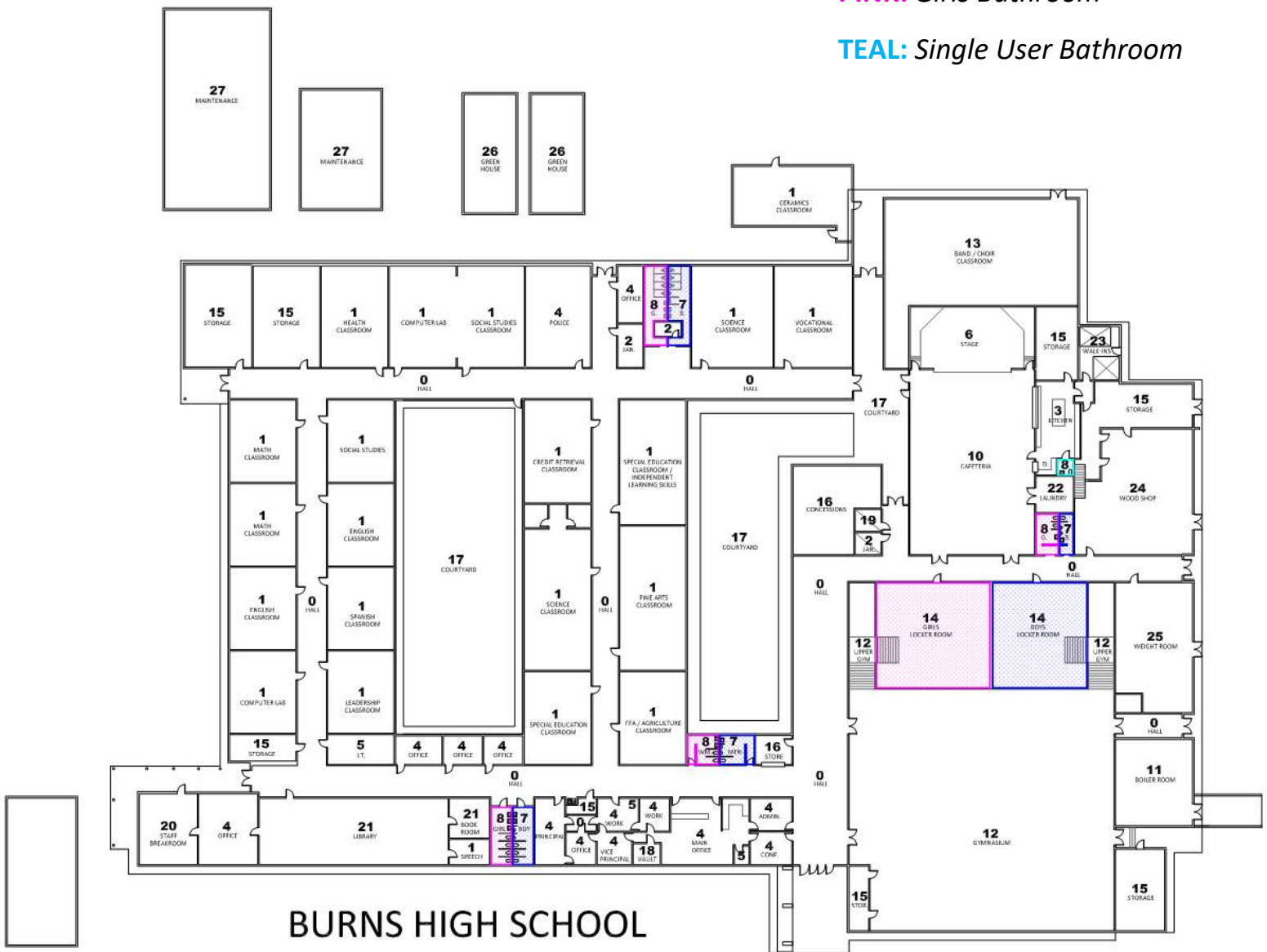

Bathroom Sq. Footage: 4,775 sq. ft



DISTRICT OFFICE

DISTRICT OFFICE

Facilities Overview

The District Office is a 3-story building located in downtown Burns, Oregon separate from all 3 school campuses. The building acts as the school district's primary administration hub housing a total of (9) office spaces including that of the superintendent, (3) conference rooms, a full gymnasium, an auditorium, and a classroom dedicated to the districts pre-school students.





ADMINISTRATION & MAINTENANCE INVENTORY

DISTRICT OFFICE

ADMINISTRATION & MAINTENANCE INVENTORY

Table 3.4a

Occupied Space	Occupied Area (sq. footage)	Floor	Type
Office Space 1	693 sq. ft	1	Administrative
Information Technology Office	668 sq. ft	1	Administrative
Girls Locker Room Office	72 sq. ft	1	Administrative
Boys Locker Room Office	69 sq. ft	1	Administrative
Gymnasium	4,625 sq. ft	1	Educational
Superintendent's Office	603 sq. ft	2	Administrative
Conference Room	658 sq. ft	2	Administrative
Office Space 2	991 sq. ft	2	Administrative
Office Space 3	942 sq. ft	2	Administrative
Information Technology Hub	44 sq. ft	2	Maintenance
Staff Break Room	600 sq. ft	3	Administrative
Office Space 4	841 sq. ft	3	Administrative
Office Space 5	184 sq. ft	3	Administrative
Conference Room 1	804 sq. ft	3	Administrative
Conference Room 2	700 sq. ft	3	Administrative
Pre-School Classroom	687 sq. ft	3	Educational
Auditorium	3,637 sq. ft	3	Educational
Stage	806 sq. ft	3	Educational
Total Administrative Sq. Footage:			7,825 sq. ft
Total Maintenance Sq. Footage:			44 sq. ft
Total Educational Sq. Footage:			9,755 sq. ft



ADMINISTRATION & MAINTENANCE INVENTORY

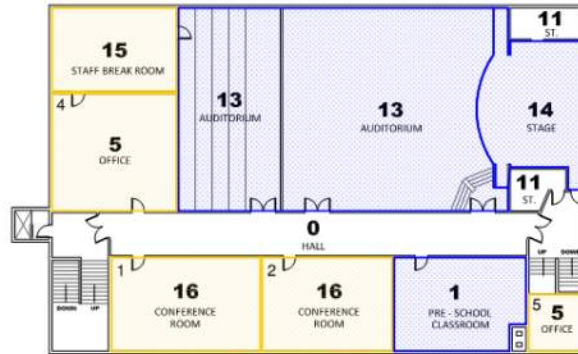

3RD FLOOR

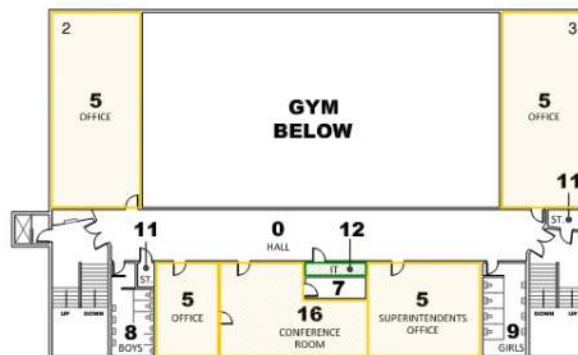

2ND FLOOR

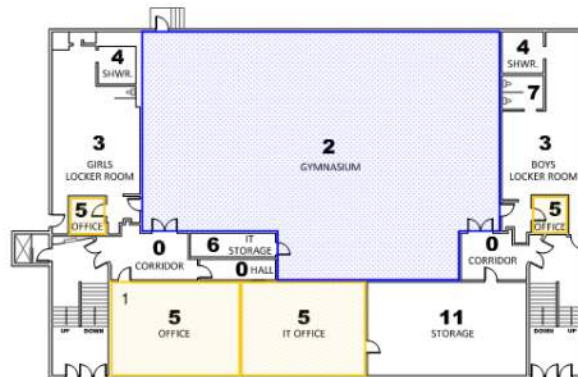

1ST FLOOR

DISTRICT OFFICE

YELLOW: Administrative

GREEN: Maintenance

BLUE: Educational



STORAGE INVENTORY

DISTRICT OFFICE
STORAGE INVENTORY

Table 3.4b

Space	Occupied Area (sq. footage)	Floor
Stage Storage 1	135 sq. ft	1
Stage Storage 2	108 sq. ft	1
Hallway Storage Closet	24 sq. ft	2
Staircase Storage Closet	41 sq. ft	2
Information Technology Storage	117 sq. ft	3
Total Storage Sq. Footage:	425 sq. ft	



STORAGE INVENTORY

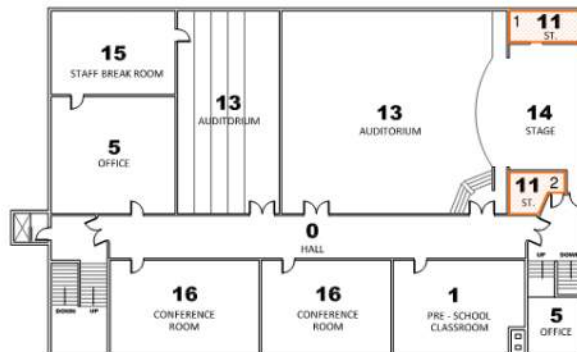

3RD FLOOR

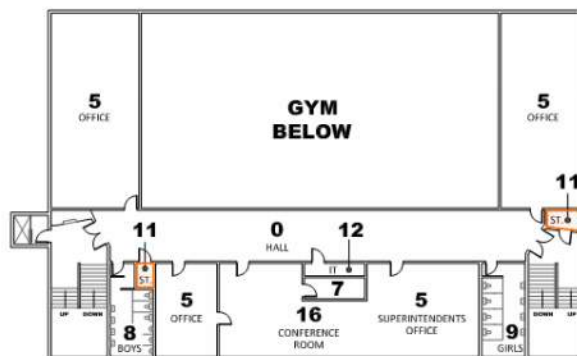

2ND FLOOR

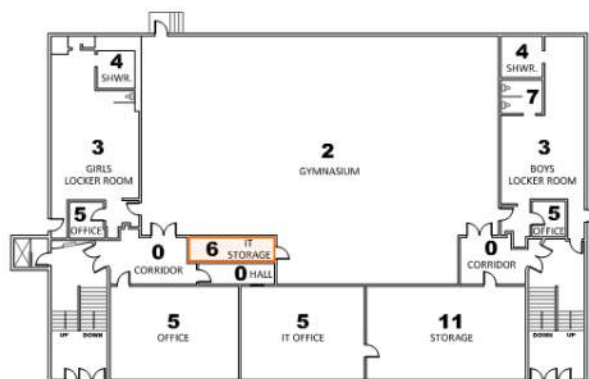

1ST FLOOR

DISTRICT OFFICE

ORANGE: Storage



BATHROOM INVENTORY

DISTRICT OFFICE BATHROOM INVENTORY

Table 3.4c

Bathroom	Occupied Area (sq. footage)	Bathroom Type	Floor	ADA Compliance
Boys Bathroom	202 sq. ft	Communal	2	Satisfactory
Girls Bathroom	231 sq. ft	Communal	2	Satisfactory
Superintendent / Conference Bathroom	74 sq. ft	Single Use	2	Unsatisfactory
Girls Locker Room	842 sq. ft	Communal	1	Satisfactory
Boys Locker Room	875 sq. ft	Communal	1	Satisfactory
Total Bathrooms: 5		ADA Compliant: 4 Bathrooms		
Total Bathroom Sq. Footage: 2,224 sq. ft		ADA Uncompliant: 1 Bathroom		



BATHROOM INVENTORY

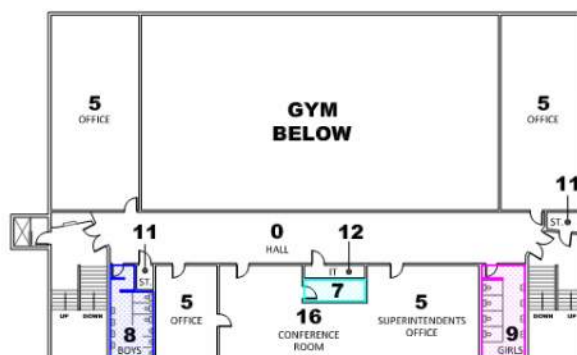
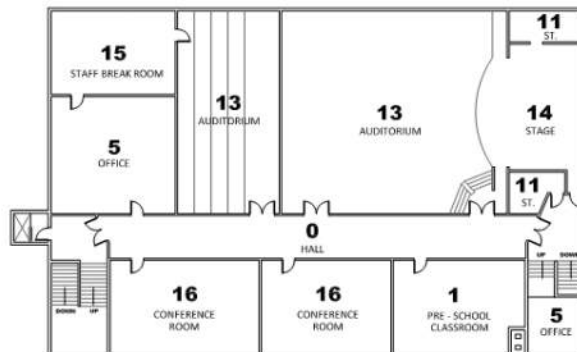

BLUE: Boys Bathroom

PINK: Girls Bathroom

TEAL: Single User Bathroom



DISTRICT OFFICE



Slater Elementary School Capacity

SLATER ELEMENTARY SCHOOL

Capacity Requirements

Slater Elementary School is at low risk for exceeding overall maximum capacity requirements now or in the future. Although the school sits at 85% capacity, there may be a need to address a minor spatial regulation discrepancy involving the kindergarten class size. The state mandates that only (25) students may occupy a single classroom KG – 3rd grade, and currently the school is 14 students (19%) over capacity regarding kindergarten classrooms overall. However, a class size tolerance is usually given to smaller school districts such as Harney County as it would only prove to be economically and logistically harmful to split the class and hire new staff to fix the issue.

The school is able to enroll up to 76 additional students (14%) before going over-capacity; according to future enrollment projections, the school is expected to undergo stagnating fluctuation along with a very small growth index over the next 21 years requiring little to no need for expansion due to growth concerns.

Table 4.1

Slater Elementary School Capacity

Grade Level	Instructional Spaces	Permanent Capacity	Enrollment	Available Capacity
Kindergarten	3	75	89	- 14
1 st Grade	4	100	65	35
2 nd Grade	3	75	64	11
3 rd Grade	3	75	73	2
4 th Grade	3	75	72	18
5 th Grade	3	75	66	24
TOTAL	19	505	429	76



Hines Middle School Capacity

HINES MIDDLE SCHOOL

Capacity Requirements

Hines Middle school is at a low risk for exceeding overall maximum capacity requirements now or in the future. The school as of now sits at 83% capacity and is able to enroll an additional 49 students before going over-capacity. Like the elementary school, the school expected to undergo stagnating fluctuation with marginal enrollment appreciation over the next 21 years. If the school were to experience an anomalous enrollment surge, an empty classroom currently being utilized as a storage room on the lower level could be recommissioned which would potentially allow the school to take in an additional 35 students which would add 13% to the permanent capacity.

Overall, the school should not expect a need for expansion due to growth within the next 21 years.

Table 4.2

Hines Middle School Capacity

Grade Level	Instructional Spaces	Permanent Capacity	Enrollment	Available Capacity
6 th Grade	8	280	87	49
7 th Grade			66	
8 th Grade			78	
TOTAL	8	280	231	49



4 School Capacity

Burns High School Capacity

BURNS HIGH SCHOOL

Capacity Requirements

Burns High School, like the other schools within the district, is at a very low risk for exceeding maximum capacity requirements now or in the near future. The school currently sits a 62% capacity and is able to enroll an additional 146 students before going over-capacity. Like the middle school, the school maintains (2) empty classrooms currently being utilized as storage rooms. If the school were to experience an anomalous enrollment surge, those two classrooms acting as storage rooms could be recommissioned, potentially allowing the school to take in an additional 70 students adding 18% to the permanent capacity.

The school, like the others in the district, is expected to undergo stagnating fluctuation with little growth index. With that fact along with the high available capacity of the school, there is no need to expect spatial expansion due to growth over the next 21 years.

Table 4.3
Burns High School Capacity

Grade Level	Instructional Spaces	Permanent Capacity	Enrollment	Available Capacity
9 th Grade	10	385	55	146
10 th Grade			67	
11 th Grade			53	
12 th Grade			64	
TOTAL	10	385	239	146

District Population Projections

HARNEY COUNTY SCHOOL DISTRICT NO. 3

The Harney County School District has two incorporated communities, Burns and Hines, within its legal boundaries and a rather large outlying bucolic population surrounding them. Roughly 77% (4,309 residents) of the total population are domiciled within city limits of either Burns or Hines, while the remaining 23% (1,312 residents) of the population occupy the surrounding rural scope of the district outside the official city limits of Burns and Hines. Although net averages by year point to slow and steady growth, gross ratio factors and outlying considerations point to a gradual decline in overall population over the next 21 years. Residents of retirement age of the district make up 20.4% of the total population (1,147 residents), which is 4.1% higher than the Oregon state average and 4.8% higher than the national average, resulting in slower than average internal growth. As for immigration and emigration projections, 5-year forecasting marks and geographical trends show the district's annual net immigration total per year is nearly identical its annual net emigration total, rendering external growth void regarding district growth. Economically, the district is performing fairly well as the cities of Burns and Hines have seen their job-markets increase by 3.2% in the last year, as well as a projected job-market percentage increase of 40.5% over the next 10 years. This economic growth in the two cities will potentially lead to a slight influx of immigration, however, does not necessarily mean more residents under the age of 18. Any unforeseen or outlying variables (such as a large factory or manufacturing plant being built in the area) could drastically affect the current district projections and would require further analysis regarding localized demographics needs to mitigate the change. However, without any unforeseen variables the district is expected to see a minimal yet gradual decline in its overall population. (See Table 5.1 on page 55)

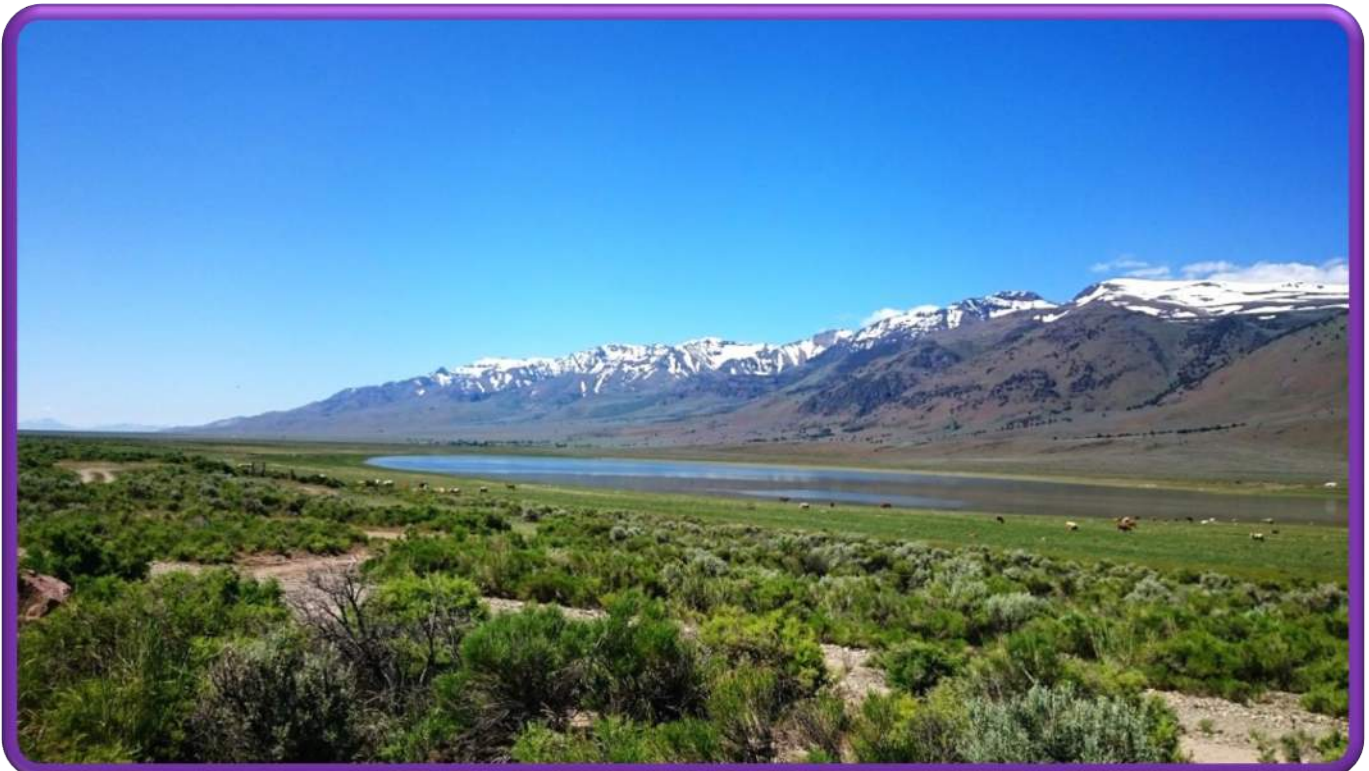

District Population Projections

Table 5.1

Harney County School Total District Population

HARNEY COUNTY SCHOOL DISTRICT Population History		
Year	Population	Increase / Decrease Percentage
2009	5,461	N/A
2010	5,935	+ 8.68%
2011	5,842	- 1.57%
2012	5,564	- 4.76%
2013	5,395	- 3.04%
2014	5,589	+ 3.60%
2015	5,557	- 0.57%
2016	5,621	+ 1.15%
Average Increase / Decrease Per Year (2009 - 2016)		
+ 0.44%		

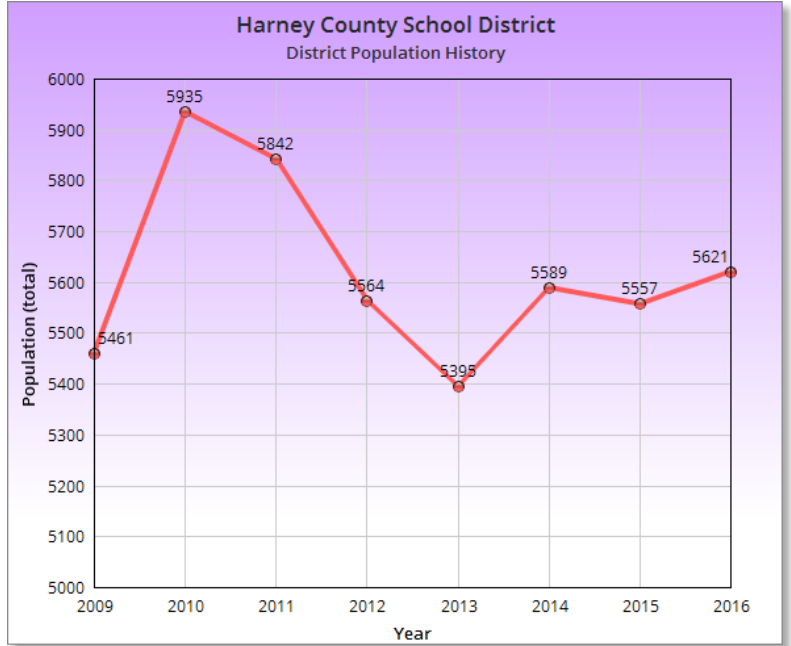

HARNEY COUNTY SCHOOL DISTRICT Population Forecasts	
Year	Population
2010	5,935
2015	5,557
2020	5,522
2025	5,463
2030	5,408
2035	5,355
2040	5,305

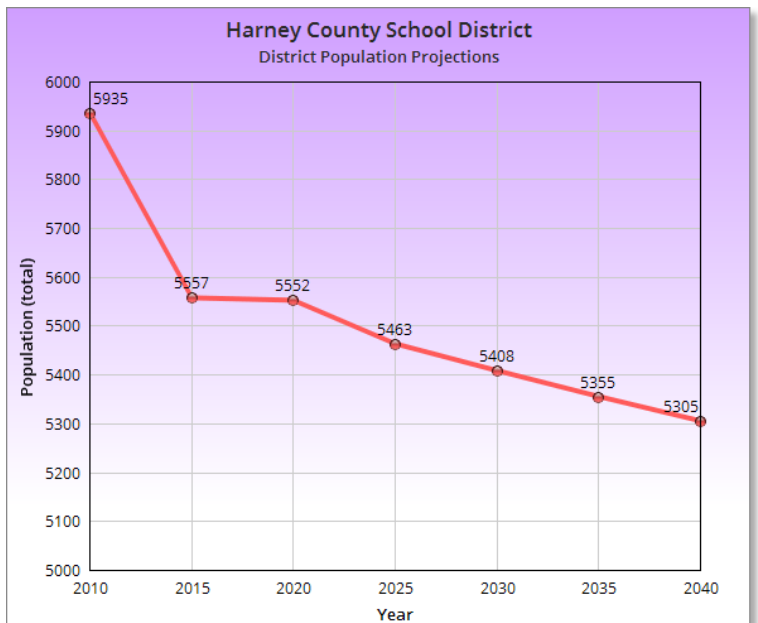



SLATER ELEMENTARY SCHOOL

ENROLLMENT PROJECTIONS

Using the most recent available census and demographic data dating back to 1990 (regarding population and enrollment of the school), Slater Elementary School is expected to see very minimal decline up to 2020 following stagnating fluctuation of 15 – 20 students along with an overall marginal enrollment depreciation over the next 21 years in-line with district growth projections, chronological trending averages, ratio factoring, and migration variables. Although over a 27-year period the school saw an average growth margin of 1.33% per year. This is most likely a result of an outlying enrollment surge in 1993 and 2004; due to the fact these surges only happened twice in a span of 27 years, they cannot be considered pertinent to the overall historical enrollment trends. All student enrollment projections are the highest possible prediction based upon several factors. Due to the sporadic enrollment history of the school and a relatively sturdy rural population, the predicted numbers are susceptible to a tolerance of (+/-) 5 – 20 students per 5-year forecast mark.

**Stagnating Fluctuation refers to a rise and fall of enrollment over an average enrollment baseline. This is very common among public schools located within rural school districts as student admission in such areas are typically volatile and sporadic.*

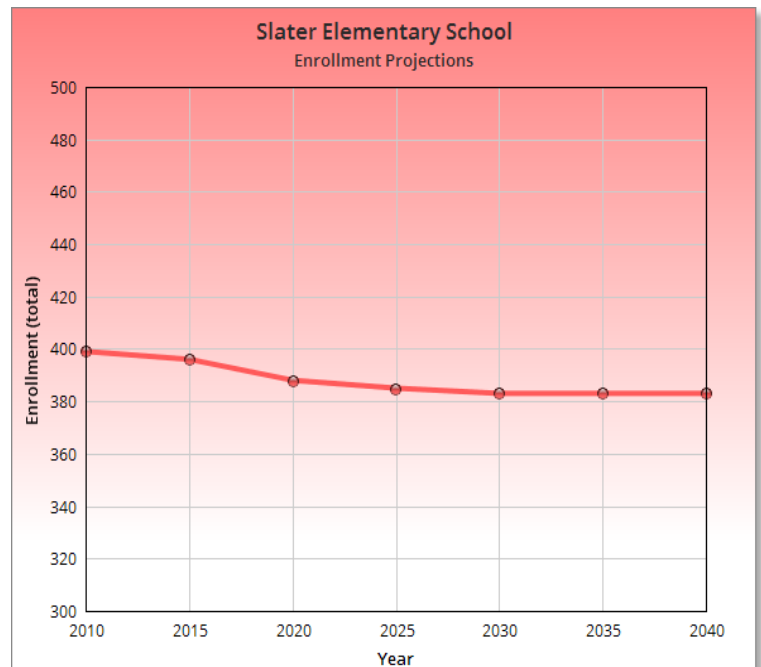
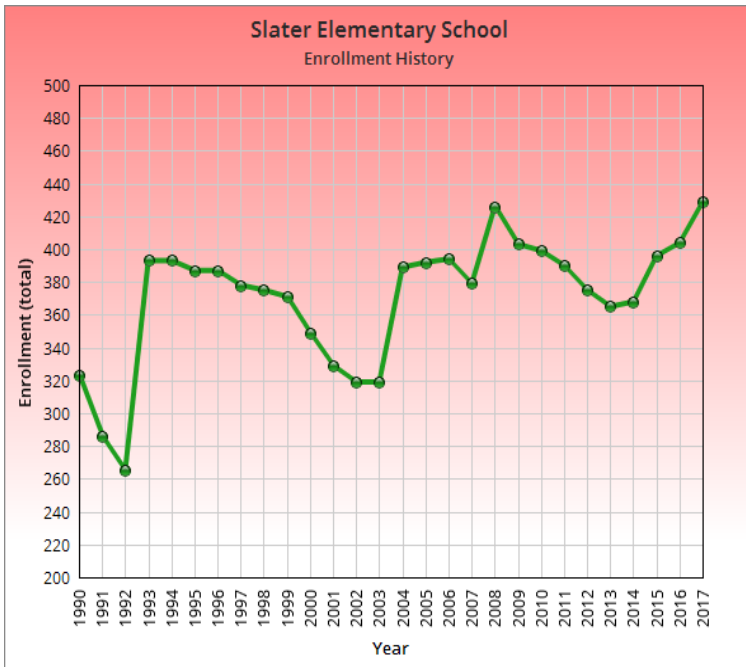



ENROLLMENT PROJECTIONS

SLATER ELEMENTARY SCHOOL		
Enrollment History		
Year	Enrollment	Increase / Decrease Percentage
1990	323	N/A
1991	286	- 11.46%
1992	265	- 7.34%
1993	393	+ 43.31%
1994	393	0.00%
1995	387	- 1.53%
1996	387	0.00%
1997	378	- 2.33%
1998	375	- 0.79%
1999	371	- 1.07%
2000	349	- 5.93%
2001	329	- 5.73%
2002	319	- 3.04%
2003	319	0.00%
2004	389	+ 21.94%
2005	392	+ 0.77%
2006	394	+ 0.51%
2007	379	- 3.81%
2008	426	+ 12.40%
2009	403	- 5.40%
2010	399	- 0.99%
2011	390	- 2.26%
2012	375	- 3.85%
2013	365	- 2.67%
2014	368	+ 0.82%
2015	396	+ 7.61%
2016	404	+ 2.02%
2017	429	+ 6.19%
Average Increase / Decrease Per Year (1990 - 2017)	Increase / Decrease from 1990 - 2017 (27 years)	
+ 1.33%	+ 32.82%	

Table 5.2a
Enrollment Forecasts

Slater Elementary School	
Enrollment Forecasts	
Year	Enrollment
2010	399
2015	396
2020	388
2025	385
2030	383
2035	383
2040	383



TEACHER TO STUDENT RATIO PROJECTIONS

SLATER ELEMENTARY SCHOOL				
Teacher to Student Ratio History				
Year	Number of Teachers	Increase / Decrease Percentage	Teacher to Student Ratio	Increase / Decrease Percentage
1990	21	N/A	15.3	N/A
1991	18	- 14.29%	15.9	+ 3.92%
1992	13	- 27.78%	20.4	+ 20.30%
1993	22	+ 68.23%	17.9	- 12.25%
1994	22	0.00%	17.9	0.00%
1995	21	- 4.55%	18.4	+ 2.79%
1996	21	0.00%	18.4	0.00%
1997	22	+ 4.76%	17.2	- 6.52%
1998	21	- 4.55%	17.9	+ 4.07%
1999	18	- 14.29%	20.6	+ 15.08%
2000	21	+ 16.67%	16.6	- 19.42%
2001	21	0.00%	15.7	- 5.42%
2002	16	- 23.81%	19.9	+ 26.75%
2003	16	0.00%	19.9	0.00%
2004	19	+ 18.75%	20.5	+ 3.02%
2005	22	+ 15.79%	17.8	- 13.17%
2006	19	- 13.64%	20.7	+ 16.29%
2007	22	+ 15.79%	17.2	- 16.91%
2008	23	+ 4.55%	18.5	+ 7.56%
2009	22	- 4.35%	18.3	- 1.08%
2010	22	0.00%	18.1	- 1.09%
2011	22	0.00%	17.7	- 2.21%
2012	20	- 9.09%	18.8	+ 6.21%
2013	19	- 5.00%	19.2	+ 2.13%
2014	20	+ 5.26%	18.4	- 4.17%
2015	18	- 10.00%	22.0	+ 19.57%
2016	21	+ 16.67%	19.2	- 12.73%
Average Increase / Decrease Per Year Number of Teachers (1990 - 2016)			Average Increase / Decrease Per Year Teacher to Student Ratio (1990 - 2016)	
+ 0.13%			+ 1.26%	

Table 5.2b

T:S Ratio Forecasts

Slater Elementary School	
Teacher-Student Ratio Projections	
Year	Number of Teachers
2010	22
2015	18
2020	20
2025	20
2030	20
2035	20
2040	20

Slater Elementary School	
Teacher Count Projections	
Year	Teacher to Student Ratio
2010	18.1
2015	22.0
2020	19.4
2025	19.3
2030	19.2
2035	19.2
2040	19.2



HINES MIDDLE SCHOOL

ENROLLMENT PROJECTIONS

Using the most recent available census and demographic data dating back to 1990 (regarding population and enrollment of the school), Hines Middle School is expected see a minimal decline in enrollment leading up to 2020 following a marginal overall enrollment appreciation up to 2040 with expected stagnating fluctuation of 10 – 15 students between each 5-year increment in-line with district growth projections, chronological trending averages, ratio factoring, and migration variables. Historically, the school accounts for sporadic enrollment trends as it saw consistent and steady growth throughout the 1990's, however, suffered an equal loss of enrollment from 2001 to 2015; the school has nearly returned to its original 1990 population as of the 2016 school year.

All student enrollment projections are the highest possible prediction based upon several factors. Due to the sporadic enrollment history of the school and a relatively sturdy rural population, the predicted numbers are susceptible to a tolerance of (+/-) 5 – 20 students per 5-year forecast mark.

**Stagnating Fluctuation refers to a rise and fall of enrollment over an average enrollment baseline. This is very common among public schools located within rural school districts as student admission in such areas are typically volatile and sporadic.*

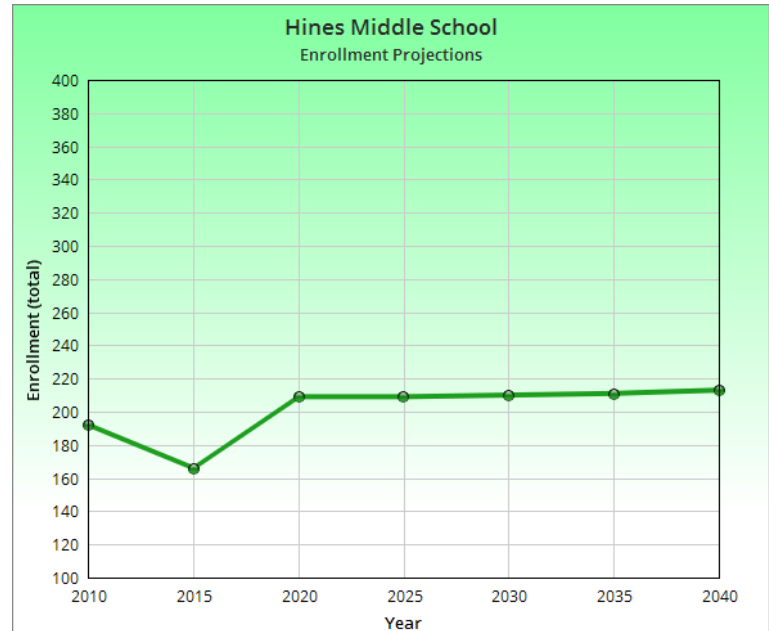
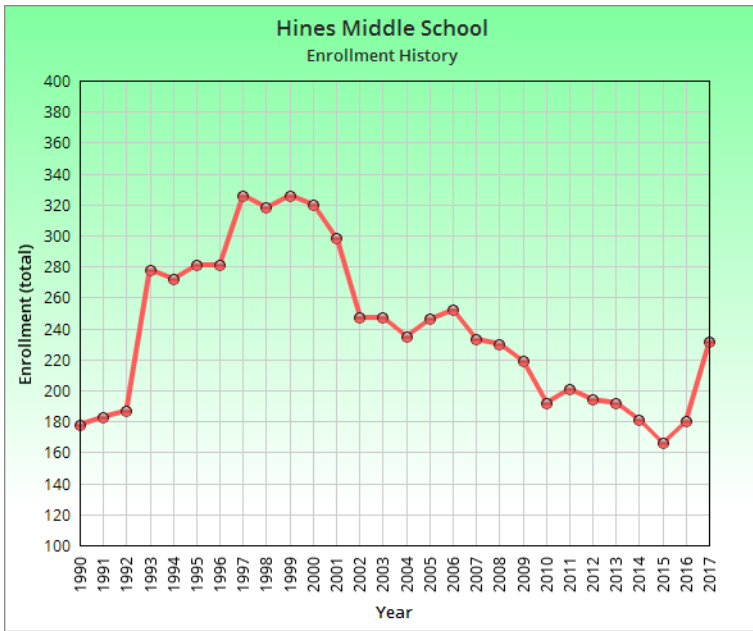



ENROLLMENT PROJECTIONS

HINES MIDDLE SCHOOL		
Enrollment History		
Year	Enrollment	Increase / Decrease Percentage
1990	178	N/A
1991	183	+ 2.81%
1992	187	+ 2.19%
1993	278	+ 48.66%
1994	272	- 2.16%
1995	281	+3.31%
1996	281	0.00%
1997	326	+ 16.01%
1998	318	- 2.45%
1999	326	+ 2.52%
2000	320	- 1.84%
2001	298	- 6.88%
2002	247	- 17.11%
2003	247	0.00%
2004	235	- 4.86%
2005	246	+ 4.68%
2006	252	+ 2.44%
2007	233	- 7.54%
2008	230	- 1.29%
2009	219	- 4.78%
2010	192	- 12.33%
2011	201	+ 4.69%
2012	194	- 3.48%
2013	192	- 1.03%
2014	181	- 5.73%
2015	166	- 8.29%
2016	180	+ 8.43%
2017	231	+ 28.33%
Average Increase / Decrease Per Year (1998 - 2017)	Increase / Decrease from 1990 - 2017 (27 years)	
+ 1.58%	+ 29.78%	

Table 5.3a

Enrollment Forecasts

HINES MIDDLE SCHOOL	
Enrollment Forecasts	
Year	Enrollment
2010	192
2015	166
2020	209
2025	209
2030	210
2035	211
2040	213



TEACHER TO STUDENT RATIO PROJECTIONS

HINES MIDDLE SCHOOL Teacher to Student Ratio History				
Year	Number of Teachers	Increase / Decrease Percentage	Teacher to Student Ratio	Increase / Decrease Percentage
1990	14	N/A	12.7	N/A
1991	14	0.00%	13.1	+ 3.15%
1992	8	- 42.86%	23.4	+ 78.63%
1993	17	+ 112.50%	16.4	- 29.91%
1994	17	0.00%	16.0	- 2.44%
1995	17	0.00%	16.5	+ 3.13%
1996	17	0.00%	16.5	0.00%
1997	18	+ 5.88%	18.1	+ 9.70%
1998	18	0.00%	17.7	- 2.21%
1999	17	- 5.56%	19.2	+ 8.48%
2000	17	0.00%	18.8	- 2.08%
2001	17	0.00%	17.5	- 6.91%
2002	15	- 11.76%	16.5	- 5.71%
2003	15	0.00%	16.5	0.00%
2004	15	0.00%	15.7	- 4.85%
2005	14	- 6.67%	17.6	+ 12.10%
2006	13	- 7.14%	19.4	+ 10.23%
2007	15	+ 15.38%	15.5	- 20.10%
2008	15	0.00%	15.3	- 1.29 %
2009	13	- 13.33%	16.8	+ 9.80%
2010	13	0.00%	14.8	- 11.90%
2011	13	0.00%	15.5	+ 4.73%
2012	13	0.00%	14.9	- 3.87%
2013	11	- 15.38%	17.5	+ 17.45%
2014	11	0.00%	16.5	- 5.71%
2015	11	0.00%	15.1	- 8.48%
2016	10	- 9.09%	18.0	+ 19.21%
Average Increase / Decrease Per Year Number of Teachers (1990 - 2016)			Average Increase / Decrease Per Year Teacher to Student Ratio (1990 - 2016)	
+ 0.85%			+ 2.74%	

Table 5.3b

T:S Ratio Forecasts

HINES MIDDLE SCHOOL Teacher Count Projections	
Year	Teacher Student Ratio
2010	13
2015	11
2020	11
2025	10
2030	10
2035	10
2040	10

HINES MIDDLE SCHOOL Teacher to Student Ratio Projections	
Year	Number of Teachers
2010	14.8
2015	15.1
2020	19.0
2025	20.9
2030	21.0
2035	21.1
2040	21.3



BURNS HIGH SCHOOL

ENROLLMENT PROJECTIONS

Using the most recent available census and demographic data dating back to 1991 (regarding population and enrollment of the school), Burns High School is anticipated to see a minimal yet gradual decline over the next 21 years along with an expected stagnating fluctuation of around 10 – 15 students per 5-year increment in-line with district growth projections, chronological trending averages, ratio factoring, and migration variables. Historical enrollment trends show steady stagnating fluctuation along a trending baseline of 320 – 360 students from 1991 through 2007, following a massive enrollment loss (33%) beginning in 2009 lasting through 2013. The past 4 years has shown gradual enrollment recovery; however, it is expected the school’s enrollment will marginally depreciate over the next 21 years.

All student enrollment projections are the highest possible prediction based upon several factors. Due to the sporadic enrollment history of the school and a relatively sturdy rural population, the predicted numbers are susceptible to a tolerance of +/- 5 – 20 students per 5-year forecast mark.

**Stagnating Fluctuation refers to a rise and fall of enrollment over an average enrollment baseline. This is very common among public schools located within rural school districts as student admission in such areas are typically volatile and sporadic.*

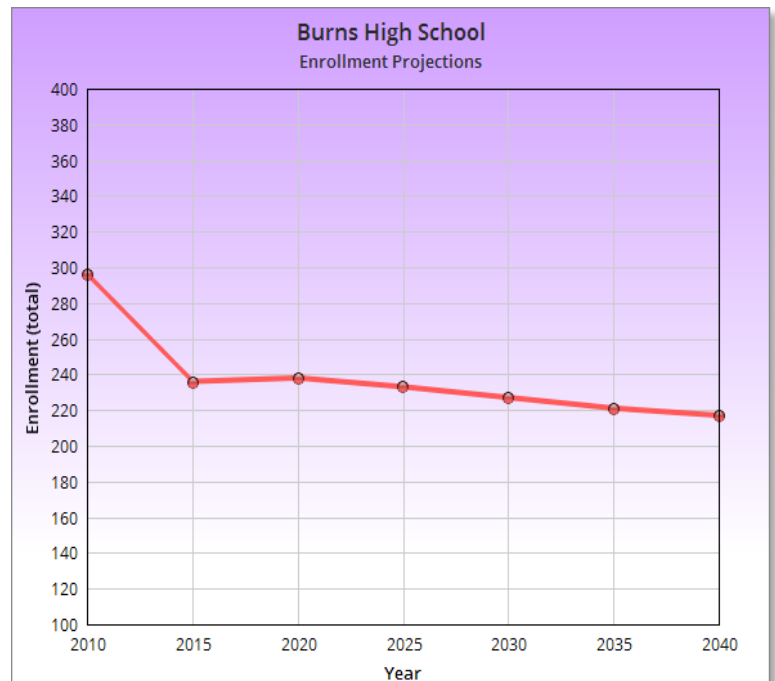
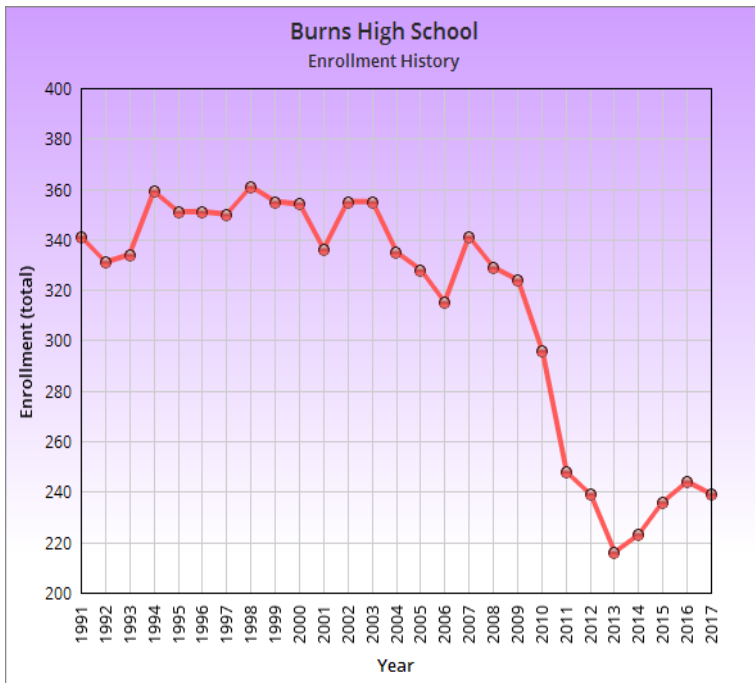



ENROLLMENT PROJECTIONS

BURNS HIGH SCHOOL		
Enrollment History		
Year	Enrollment	Increase / Decrease Percentage
1991	341	N/A
1992	331	- 2.93%
1993	334	+ 0.91%
1994	359	+ 7.49%
1995	351	- 2.23%
1996	351	0.00%
1997	350	- 0.28%
1998	361	+ 3.14%
1999	355	- 1.66%
2000	354	- 0.28%
2001	336	- 5.08%
2002	355	+ 5.65%
2003	355	0000%
2004	335	- 5.63%
2005	328	- 2.09%
2006	315	- 3.96%
2007	341	+ 8.25%
2008	329	- 3.52%
2009	324	- 1.52%
2010	296	- 8.64%
2011	248	- 16.21%
2012	239	- 3.63%
2013	216	- 9.62%
2014	223	+ 3.24%
2015	236	+ 5.83%
2016	244	+ 3.39%
2017	239	- 2.05%
Average Increase / Decrease Per Year (1991 - 2017)	Increase / Decrease from 1991 - 2017 (25 years)	
- 1.16%	- 29.91%	

Table 5.4a
Enrollment Forecasts

BURNS HIGH SCHOOL	
Enrollment Forecasts	
Year	Enrollment
2010	296
2015	236
2020	238
2025	233
2030	227
2035	221
2040	217



TEACHER TO STUDENT RATIO PROJECTIONS

BURNS HIGH SCHOOL Teacher to Student Ratio History				
Year	Number of Teachers	Increase / Decrease Percentage	Teacher to Student Ratio	Increase / Decrease Percentage
1991	23	N/A	14.8	N/A
1992	21	- 8.70%	15.8	+ 6.76%
1993	23	+ 9.52%	14.5	- 8.23%
1994	21	- 8.70%	17.1	+ 17.93%
1995	21	0.00%	16.7	- 2.34%
1996	21	0.00%	16.7	0.00%
1997	19	- 9.52%	18.4	+ 10.18%
1998	21	+ 10.53%	17.2	- 6.52%
1999	18	- 14.29%	19.7	14.53%
2000	20	+ 11.11%	17.7	- 10.15%
2001	20	0.00%	16.8	- 5.08%
2002	20	0.00%	17.8	+ 5.95%
2003	20	0.00%	17.8	0.00%
2004	19	- 5.00%	17.6	- 1.12%
2005	20	+ 5.26%	16.4	- 6.82%
2006	18	- 10.00%	17.5	+ 6.71%
2007	20	+ 11.11%	17.1	- 2.29%
2008	20	0.00%	16.5	- 3.51%
2009	18	- 10.00%	18.0	+ 9.09%
2010	18	0.00%	16.4	- 8.89%
2011	17	- 5.56%	14.6	- 10.98%
2012	17	0.00%	14.1	- 3.42%
2013	17	0.00%	12.7	+ 9.93%
2014	14	- 17.65%	15.9	+ 25.20%
2015	17	+ 21.43%	13.9	- 12.58%
2016	16	- 5.88%	15.3	+ 10.07%
Average Increase / Decrease Per Year Number of Teachers (1991 - 2016)			Average Increase / Decrease Per Year Teacher to Student Ratio (1991 - 2016)	
- 1.05%			+ 1.38%	

Table 5.4b

T:S Ratio Forecasts

BURNS HIGH SCHOOL Teacher Count Projections	
Year	Teacher Student Ratio
2010	18
2015	17
2020	15
2025	14
2030	13
2035	13
2040	12

BURNS HIGH SCHOOL Teacher to Student Ratio Projections	
Year	Number of Teachers
2010	16.4
2015	13.9
2020	15.9
2025	16.6
2030	17.5
2035	17.0
2040	18.1

Future Capacity Requirements

As the chart below shows (Table 6.1), Slater Elementary School and Burns High School are expected to see slight decline in enrollment while Hines Middle School is projected to see a slight rise in enrollment over the next 20 years. Although there is a minor gross rise / fall in enrollment based upon enrollment projections, the data points that that the enrollment of all (3) schools will undergo stagnating student enrollment fluctuation in the years between. These projections lead to the conclusion that there should be little to no concern for the district to initiate growth development planning or construction of new facilities solely due to growth. The only discrepancies the district need be aware of regarding capacity concerns lie within the kindergarten class, as the current capacity for kindergarteners at Slater Elementary School is (14) students over the mandated threshold. Other classroom additions and/or renovations may ensue in correlation with changes to federal and state education mandates and technological advancement.

Table 6.1
Future Capacity Requirements

School	Adjusted Instructional Spaces	Adjusted Permanent Capacity	Projected 2020/2021 Enrollment	Change In Capacity	Projected 2030/2031 Enrollment	Change In Capacity	Projected 2040/2041 Enrollment	Change In Capacity
Slater Elementary School	19	505	388	+ 11	385	+ 3	383	+ 2
Hines Middle School	8	280	209	- 17	210	- 1	213	- 3
Burns High School	10	385	238	+ 58	227	+ 11	217	+ 10

*All forecasts and predictions are based off census data, demographic data, and historical trends within the district. These calculations and forecasts may be subject to change if any unforeseeable variables and changes occur within the district.
i.e. – Construction of large factories or plants that bring thousands of people to the district, etc.

Preliminary Bond Scope of Work

The Building Committee, School Board, School Superintendent, & Architect has compiled the following scope of work in order to establish the Preliminary Bond Amount. Financial information provided by the school districts Bond consultant was used to determine bond ideal bond capacity.

\$8M Bond + \$4M OSCIM Grant = \$12M

SLATER K-8 SCHOOL

Classroom Building	20,000 SF	\$250 PER/SF	\$ 5.0M
Gymnasium	7,100 SF	\$200 PER/SF	\$ 1.4M
Locker Rooms	1,100 SF	\$300 PER/SF	\$ 300K
Kitchen & Cafeteria Remodel & Addition	3,200 SF	\$220 PER/SF	\$ 700K
Site Work, Bus loop, Parking Lot	26,000 SF	\$20 PER/SF	\$ 500K
Secure Entry			\$ 50K
Remodel & Deferred Maintenance			\$ 500K

SUB-TOTAL \$8.45M

HIGH SCHOOL

Concessions, Toilets, & Wrestling Room	4,400 SF	\$200 PER/SF	\$ 880K
Kitchen Remodel & Expansion	1,900 SF	\$250 PER/SF	\$ 500K
Secure Entry			\$ 61K
Deferred Maintenance			\$ 350K

SUB-TOTAL \$ 1.8 M

HINES DISTRICT OFFICES & STORAGE

Deferred Maintenance & Remodel \$150K

FINAL COSTS

CONSTRUCTION (Total from Above)	\$ 10.4M
SOFT COSTS	\$ 800K
CONTINGENCY (5%)	\$ 500K
INFLATION MULTIPLIER (2.5%)	\$ 300K

TOTAL \$ 12M



When determining the best use of bond funding there are four main considerations;

1. Student Population & Growth
2. Building Condition
3. Adequate Programming Space
4. Health, Life, Safety, Accessibility & Security

Student Population & Growth - The Harney County school District is projected to gradually increase in student population along all grade levels. This means that overall student population is most likely to gradually increase. Its important to noate that individual grade populations will ebbe and flow from year to year.

Buidling Condition - The Harney County School district facilites range in age from 1928 to 1965. The most recent building project was the addition of an elevator & kitchen storage to the Hines facility done in 2008. The facilities have been maintained well over the years, the RCI index for all educational facilites are slightly elevated. Deferred maintenance and building finishes are the largest contributing factors. The existing District Office RCI has deemed that the facility is not economically feasible to remodel or rennovate.

Adequate Program Space – The existing classroom program spaces all grade levels have capacity for existing and future enrollement up to 2040 based on the findings of this report. The support spaces such as the Future K-8 kitchen, High School Kitchen, are undersized or non-existent based upon todays requirements.

Health, Life, Safety, Accessabilty & Security – Its very common that older facilities lack current Health, Life, Safety, Accessabilty & Security standards which are implemented in modern Schools. Pilot rock is no exception. The School District has done an excellet job about being proactive in addressing such standards over the years, but there are improvements still needed.

Facility Consolidation Narrative – The findings of this report along with the Facility Committee input suggests the following bond approach and Facility Consolidation be the most value driven approach for the future of Harney County School District;

1. Mothball Old Lincoln district offices and move district offices to Hines.
2. Move Hines Middle school students to Slater Elementary.
3. Construct new classrooms & Gymnasium at Slater Elementary and convert to K-8 facility

Lost Program space from Old Lincoln – By mothballing Old Lincoln, District office space, and auditorium and gymnasium will be lost program space. District office space will be recaptured at Hines. The Gymnasium will be replaced by the new gymnasium at Slater. The existing Cafatorium (Combined Cafeteria & Auditorium space) at the High school will be reutilized.

THE FOLLOWING SCOPE OF WORK OUTLINES CONCLUSIONS AND RECOMMENDATIONS BASED UPON REPORT FINDINGS AND THE BUILDING COMMITTEE INSTRUCTION:

BOND AMOUNT: \$8M + \$4M OSCIM GRANT POTENTIAL

- A) OLD LINCOLN DIST. OFFICES (34.7% RCI – FUTURE BUDGET \$0 Sell Building)
- Sell / mothball
 - Building mainly relevant due to Gymnasium, Stage, and district offices.
 - Relocate district offices to Hines
- B) HINES (15.9% RCI – FUTURE BUDGET \$150K)
- Consolidate Middle school Classrooms to Slater
 - Maintain Existing Gym for School District use
 - Remodel occupied district office areas
 - Retain remainder of existing building for district Storage
- C) SLATER (19.7% RCI – FUTURE BUDGET \$8.45M)
- Repair existing facility deferred Maintenance
 - Expand campus to include Hines student population (K-8)
 - New Middle School classrooms
 - New Middle School Gymnasium
 - New Parking Lot
 - New Student & Bus drop off areas
 - Remodel of Existing Kitchen
 - Expansion of existing cafeteria
 - Construction of Secure Vestibule at main entry
- D) HIGH SCHOOL (9.4% RCI – FUTURE BUDGET \$1.8M)
- Repair existing facility deferred Maintenance
 - Remodel of Existing Kitchen
 - Remodel and expand Existing Kitchen
 - Repopulate empty classrooms
 - Provide new Concessions, Restrooms, & Wrestling Gymnasium building
 - Construction of Secure Vestibule at main entry

NOTE: For complete bond costs see Page 66 (District Facilities Financing)

8 Conclusions and Recommendations



SLATER K-8 PRELIMINARY PROGRAMMING

RED = NEW CONSTRUCTION

GREEN = REMODELED SPACE

8 Conclusions and Recommendations

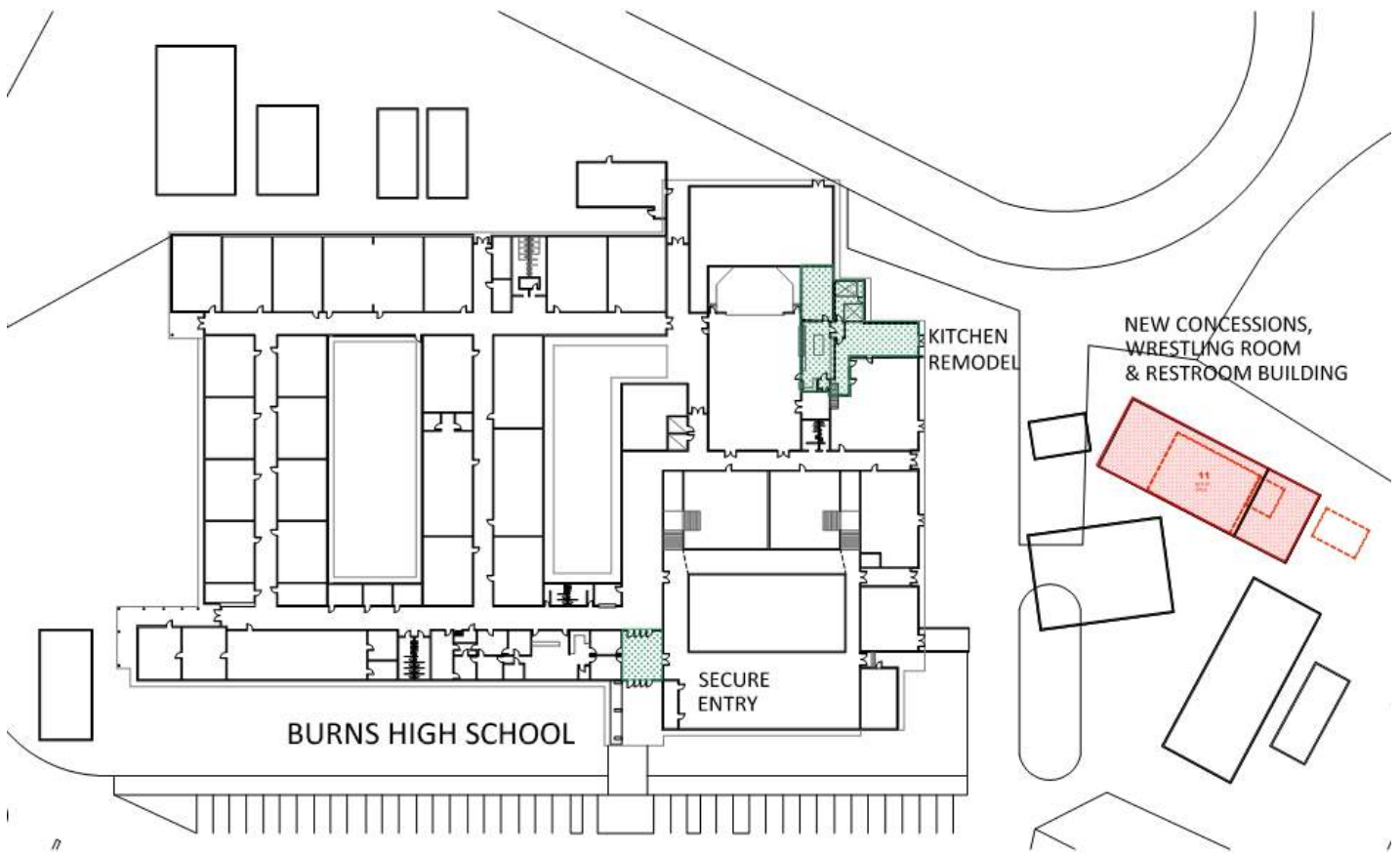

HIGH SCHOOL PRELIMINARY PROGRAMMING

RED = NEW CONSTRUCTION

GREEN = REMODELED SPACE

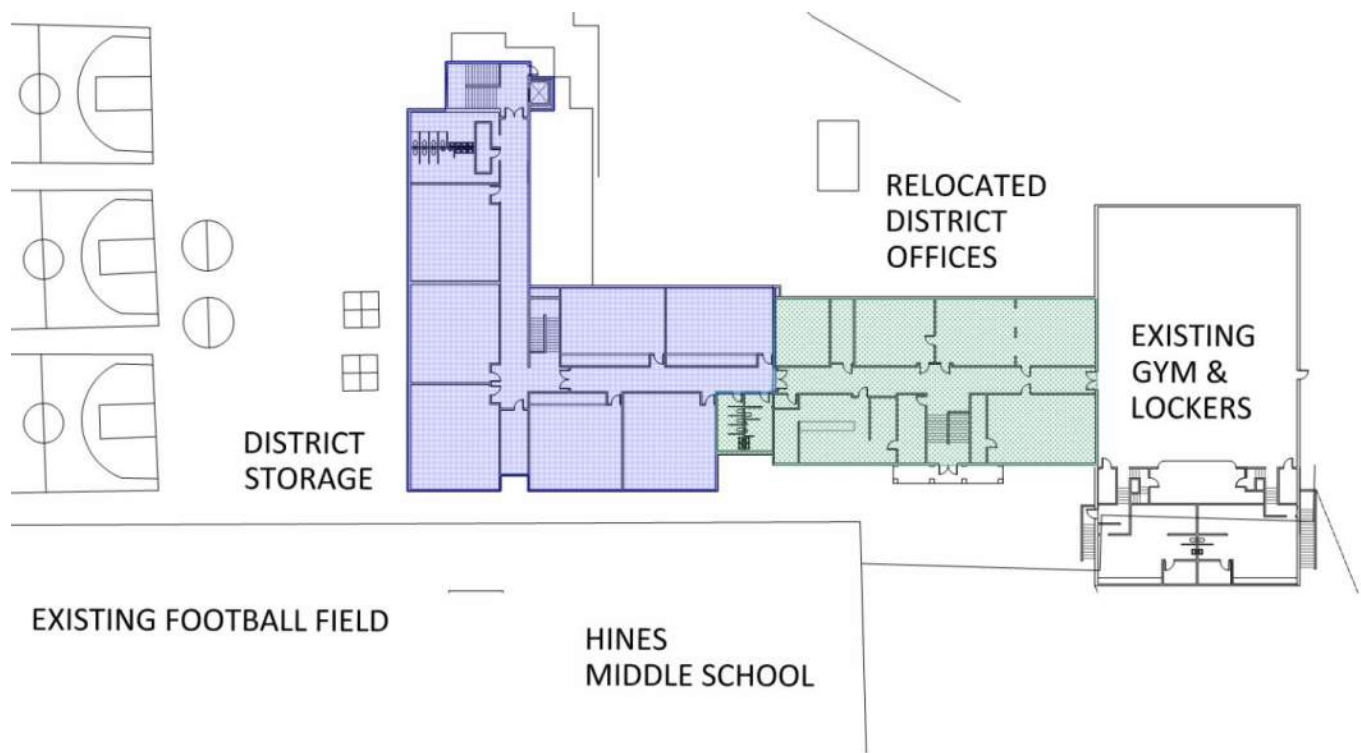

HINES PRELIMINARY PROGRAMMING

GREEN = REMODLED SPACE

BLUE = REPURPOSED SPACE

Site Information

SLATER ELEMENTARY SCHOOL

800 North Fairview Avenue
Burns, Oregon 97720
(541) 573-7201

Principal: Sid Hobgood

Year of Construction: 1948

Site Size (Acres): 8.43 acres

Facility Size (Sq. Ft.): 54,356 sq. ft

Core Teaching Stations: 19

Grades: K – 5

Enrollment (2017-2018): 429

Capacity: 505



Overview

Slater Elementary School, constructed in 1948, is situated on an 8.43-acre campus due northwest of the city center of Burns, Oregon. The school maintains (2) single-story primary instructional facilities fairly adjacent to each other along with (3) separated storage buildings and a Biomass Generator located at the western end of campus. The site also includes (2) playground zones centrally located between the two main facilities as well as full-size basketball courts on the southern end of the rear facility. Total enrollment as of the most recent full school-year (2017-2018) sits at 429 students ranging from kindergarten to 5th grade; this is 76 students (15%) below the school's maximum capacity threshold of 505. Of the total district population, 20.25% are under the age of 18, which is 3.76% lower than the national average. The facility itself is spatially satisfactory in maintaining the current number of students, however, are 19% over-capacity regarding the overall kindergarten class size. The school has seen appreciating volatile stagnating enrollment fluctuation over the past 27 years, contributing to the annual average 1.33% increase in enrollment since 1990. However, the historical data points to a few select years where anomalous enrollment surges took place which distortedly imbalanced the trend line from negative to positive as the growth margin of those years boosted the gross average. As for future enrollment, the school is expected to continue the trend of stagnating fluctuation with slight depreciation in total student enrollment over the next 21 years to 2040. The districts total population is expected to decrease roughly 4.6% according to numerous factors leading up to 2040, which falls in-line with school enrollment forecasts.

Site Information

HINES MIDDLE SCHOOL

500 West Barnes Avenue
Hines, Oregon 97738
(541) 573-6436

Principal: Brittany Waggoner

Year of Construction: 1930

Site Size (Acres): 6.55 acres

Facility Size (Sq. Ft.): 44,615 sq. ft

Core Teaching Stations: 8

Grades: 6 – 8

Current Enrollment (2018-2019): 231

Capacity: 280



Overview

Hines Middle School, originally constructed in 1930 as the community's grade school, is situated on a 6.55-acre campus oriented just northwest of the center of Hines, Oregon. The school maintains a single 2-story facility surrounded by a large open grass field to its southeast and (3) basketball courts to its south. Total enrollment per the most recent full school-year (2017-2018) sits at 231 students ranging from 6th to 8th grade, 49 students (18%) below the school's maximum capacity threshold of 280. Of the total district population, 20.25% are under the age of 18, which is 3.76% lower than the national average. The facility itself is spatially satisfactory in maintaining the current number of students, as well as having an extra classroom currently being utilized as storage which could potentially be recommissioned to add an additional 35 students (13%) to the overall capacity of the school if an anomalous enrollment surge were to occur. The school has seen somewhat depreciating volatile stagnating enrollment fluctuation over the past 27 years, however due to outlying enrollment surges on a select few school years, has had an overall annual average 1.58% increase in enrollment since 1990. As for future enrollment, the school is expected to continue the trend of stagnating fluctuation with slight appreciation in total enrollment over the next 21 years leading up to 2040. The districts total population is expected to decrease roughly 4.6% according to numerous factors leading up to 2040, which falls in-line with school enrollment forecasts.

Site Information

BURNS HIGH SCHOOL

1100 Oregon Avenue
Burns, Oregon 97720
(541) 573-2044

Principal: Robert Medley

Year of Construction: 1959

Site Size (Acres): 33.49 acres

Facility Size (Sq. Ft.): 81, 976 sq. ft

Core Teaching Stations: 10

Grades: 9 – 12

Current Enrollment (2018-2019): 239

Capacity: 385



Overview

Burns High School, constructed in 1959, is situated on a 33.49-acre campus on the southern tail-end of Burns, Oregon. The school maintains a larger single-story facility along with (3) smaller buildings north of school acting as vocational classrooms as well as a boiler shed and (2) small structures west of the school acting as maintenance buildings. The campus also maintains a full track and football field, (2) baseball diamonds, (2) tennis courts, and a separate outdoor swimming pool facility which is located northeast of the school. Total enrollment per the last full school-year sits at 239 students ranging from 9th to 12th grade, 146 students (38%) below the school's maximum capacity threshold of 385. Of the total district population, 20.25% are under the age of 18, which is 3.76% lower than the national average. The facility itself is spatially satisfactory in maintaining the current number of students, as well as maintaining (2) unused classrooms acting as storage space which could potentially be recommissioned to add an additional 70 students (18%) to the overall capacity of the school if an anomalous enrollment surge were to occur. The school has seen depreciatingly volatile stagnating enrollment fluctuation over the past 26 years as well as a massive enrollment loss from 2009 – 2013, contributing to an annual average gross 1.16% loss in enrollment since 1991. As for future enrollment, the school is expected to continue the trend of stagnating fluctuation with slight depreciation in total enrollment over the next 21 years leading up to 2040. The districts total population is expected to decrease roughly 4.6% according to numerous factors leading up to 2040, which falls in-line with school enrollment forecasts.

Sources & Methods

All enrollment forecasts, district population projections, and TS Ratios are done through data from all available census and local demographic data, local economic trends, and labor data. Forecasts and projections having to do with enrollment and population deliberate with all what is listed above. Using population ratios, average percentage indexes, projected immigration due to job growth, projected local projected growth not due to immigration, projected migration, and economic forecasting we can solidify an accurate and well-adjusted prediction.

All projected numbers are subject to change due to unforeseen future outlying variables such as commercial and industrial development, economic growth or decline, private school trends, etc. all of which could bring or take hundreds of jobs into the district.

- ❖ **Population Ratios:** Using the most up-to-date census data overall county population is overlaid with the school district's population to determine an historical ratio multiplier. This multiplier is used in conjunction with other variables to predict a future population Forecast for not only overall population but as a predictor for future enrolment numbers.
- ❖ **Average Percentage Index:** Using historically defined population census data of the district, average growth or loss estimations are derived. Comparing these averages to similar data derived from local, state, and national percentage averages determine future rate of growth or decline.
- ❖ **Immigration & Emigration:** 20-year immigration / emigration records are utilized to forecast future district population and enrollment growth index. Growth factors are highly susceptible to change in forecasted numbers due to a vast number of possible outlying variables. In rural areas this variable has the potential to drastically change the districts population and enrollment.
- ❖ **Projected Growth not due to Immigration:** Using the projected inter-growth rate coupled with projected average family size per household over 20 years we can predict how many people will be added to the district without immigration or emigration numbers. Of course, this number is combined with all factors to produce a growth index.

Sources & Methods

Sources List

www.census.gov

www.bls.gov

www.catalog.data.gov

www.socialexplorer.com

www.greatschools.org

www.schooldigger.com

www.oregon-demographics.com

<http://www.bestplaces.net>



D | A | DAVIDSON
FIXED INCOME CAPITAL MARKETS

Investment Banking Presentation for:



HARNEY COUNTY
SCHOOL DISTRICT 3

Matt Donahue
Managing Director
Public Finance
503.863.5094
mdonahue@dadco.com

February 26, 2019

D.A. DAVIDSON & CO.
Oregon Public Finance
1300 S.W. 5th Avenue, Suite 1950
Portland, Oregon

General Obligation Bond Preliminary Estimates - \$5 Million Project

- This scenario assumes the District will issue bonds to fund a \$5.0 million project in December 2019 (November 2019 Election)
- The debt service is structured to result in an estimated levy increase of \$0.10/1000 for 30 years
- If awarded, the District could receive a matching grant of up to \$4.0 million from the Oregon School Capital Improvement Matching Program, based on the total proceeds borrowed

Schedule of Sources and Uses of Funds		Bond Statistics	
Sources of Funds		Timing and Interest Rate	
Par Amount	\$4,931,014.50	Dated Date	12/15/2019
Bond Premium	169,834.90	Bond Yield (Reinvestment Limit)	4.67%
Total Proceeds	\$5,100,849.40	True Interest Rate (including costs)	4.80%
Uses of Funds		Average Life of Bonds	23.01 years
Project Fund Deposit	\$5,000,000.00	Bond Levy / Debt Service	
Costs	100,849.40	Levy Rate (Level Levy)	\$0.67/\$1,000 AV
Total Uses	\$5,100,849.40	Final Maturity	6/15/2050
		Call Date (Prepayment Date for Refinancing)	12/15/2029

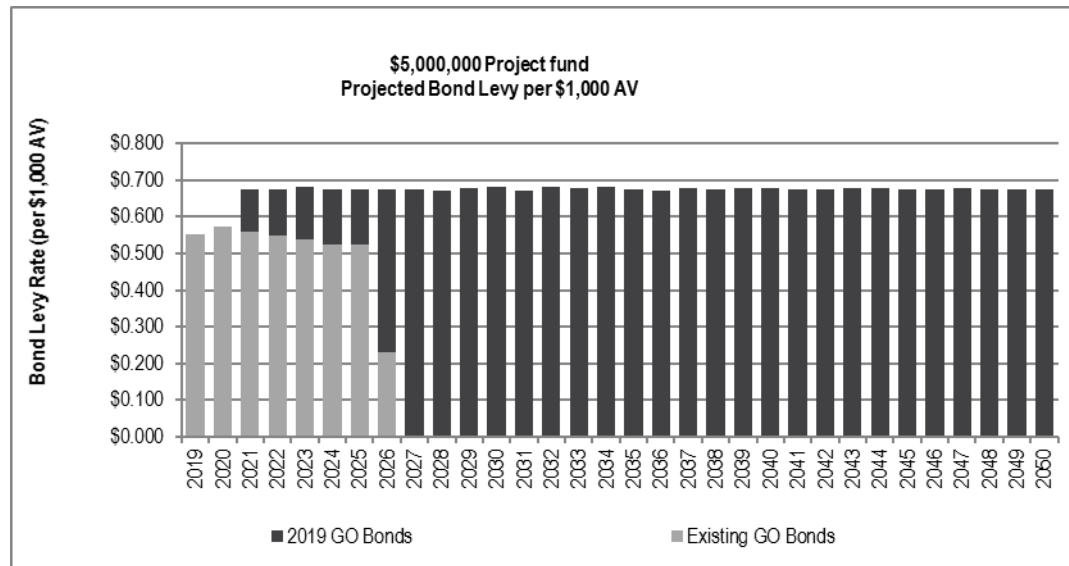

- Results based on indicative borrowing rates as of February 25, 2019 plus 50 basis points (0.50%)
- Assumes the District's Taxable Assessed Value future annual growth rate is 3.25% and assumed Collection Rate of 97.0%.
- All costs of issuance are assumed paid from proceeds of the new bond sale

General Obligation Bond Preliminary Estimates - \$8.5 Million Project

- This scenario assumes the District will issue bonds to fund a \$8.5 million project in December 2019 (November 2019 Election)
- The debt service is structured to result in an estimated bond tax levy increase of \$0.57/1000 for 30 years
- If awarded, the District could receive a matching grant of up to \$4.0 million from the Oregon School Capital Improvement Matching Program, based on the total proceeds borrowed

Schedule of Sources and Uses of Funds		Bond Statistics	
Sources of Funds		Timing and Interest Rate	
Par Amount	\$8,326,837.90	Dated Date	12/29/2019
Bond Premium	304,298.55	Bond Yield (Reinvestment Limit)	4.53%
Total Proceeds	\$8,631,136.45	True Interest Rate (including costs)	4.63%
Uses of Funds		Average Life of Bonds	22.29 years
Project Fund Deposit	\$8,500,000.00	Bond Levy / Debt Service	
Costs	131,136.55	Levy Rate (Level Levy)	\$1.04/\$1,000 AV
Total Uses	\$8,631,136.55	Final Maturity	6/15/2050
		Call Date (Prepayment Date for Refinancing)	12/15/2029

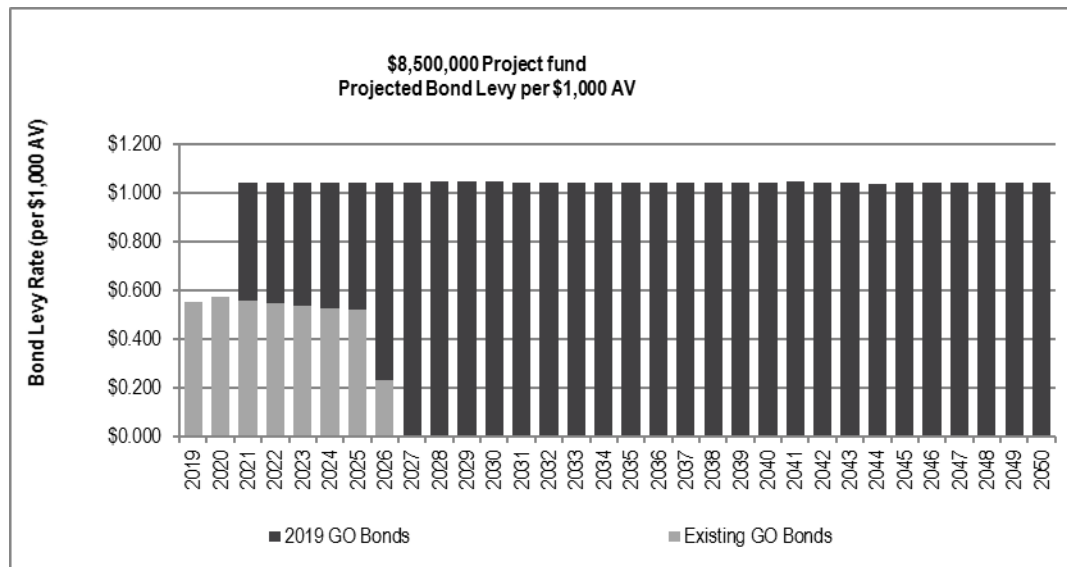

- Results based on indicative borrowing rates as of February 25, 2019 plus 50 basis points (0.50%)
- Assumes the District's Taxable Assessed Value future annual growth rate is 3.25% and assumed Collection Rate of 97.0%.
- All costs of issuance are assumed paid from proceeds of the new bond sale



Potential projects

Matt Donahue <mdonahue@dadco.com>
To: Steven Quick <quicks@harneyesd.k12.or.us>

Tue, Mar 5, 2019 at 3:53 PM

Hi Steve,

Please see below a matrix showing the estimated bond levy rates by project size and length of term of the new bond. Assumptions for the estimates are shown below the table.

If you have any questions, don't hesitate to give me a call. Let me know if you need any additional information. Thank you, Matt

Estimated Annual Tax Levy Rate Over Life of Bond Per \$1000 of Taxable Assessed Property Value		
	<i>\$5 million Project</i>	<i>\$8.5 million Project</i>
<i>20-year</i>	\$.92	\$1.41
<i>25-year</i>	\$.78	\$1.21
<i>30-year</i>	\$.67	\$1.04

- *Results based on indicative borrowing rates as of February 25, 2019 plus 50 basis points (0.50%)*
- *Assumes the District's Taxable Assessed Value future annual growth rate is 3.25% and Tax Levy Collection Rate of 97.0%.*